

FEDERAL-AID PROJECT STPL-5938(236) RSTP OVERLAY PHASE I STANISLAUS COUNTY, CALIFORNIA

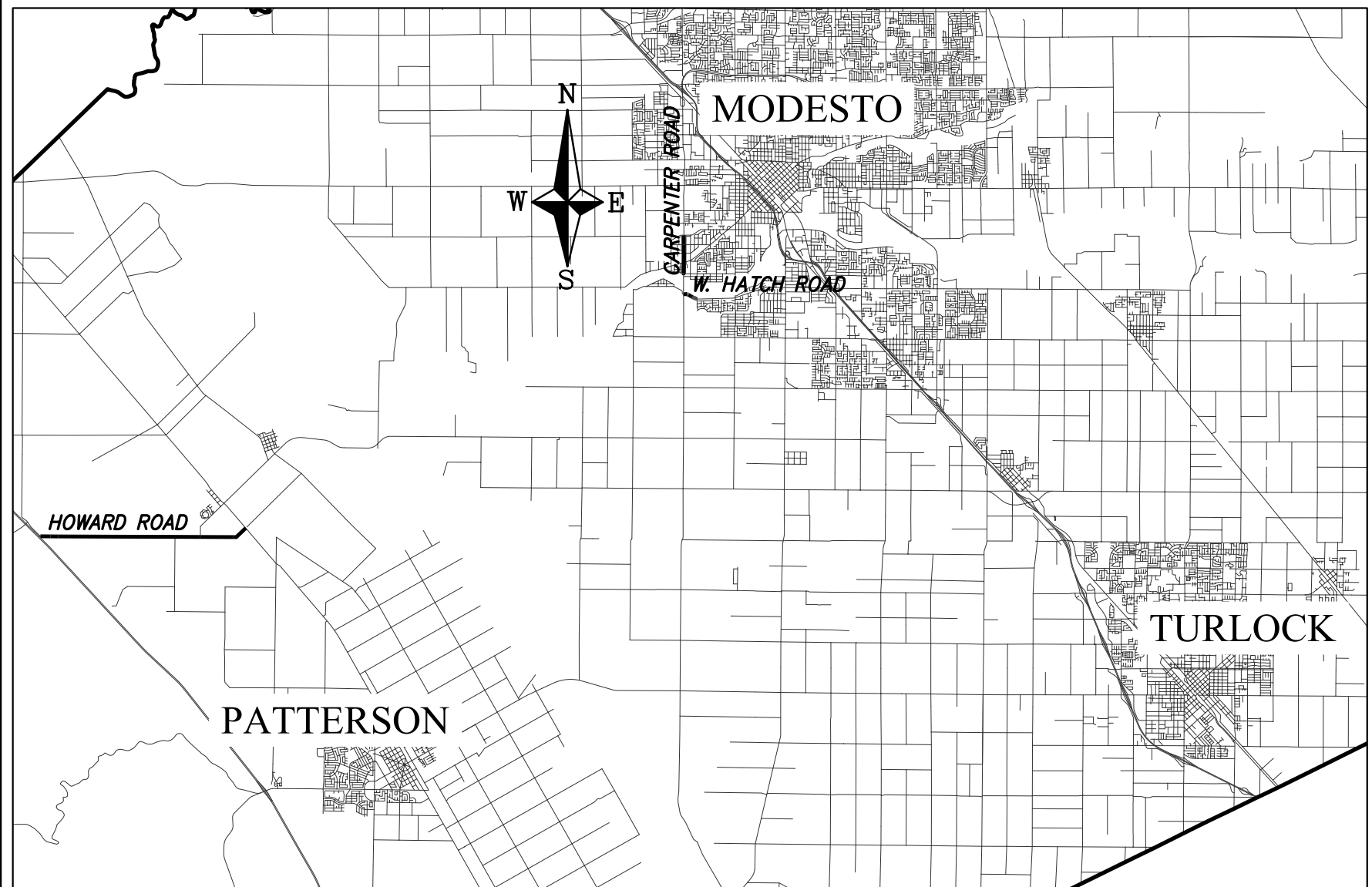

NO.	REVISIONS	DATE	APPROVED



STANISLAUS COUNTY
NTS

INDEX

SHEET	DESCRIPTION
1	COVER SHEET
2	HOWARD ROAD & CARPENTER ROAD
3	CARPENTER ROAD
4	WEST HATCH ROAD
5	PARADISE AND CARPENTER ROAD INTERSECTION ADA IMPROVEMENTS NE & SW CORNERS
6	PARADISE AND CARPENTER ROAD INTERSECTION ADA IMPROVEMENTS NW & SE CORNERS
7	CARPENTER ROAD STRIPING PLAN
8	CARPENTER ROAD STRIPING PLAN
9	CONSTRUCTION DETAILS
10	STRIPING PLAN, MONUMENT LOCATIONS & METERED SERVICE PEDESTAL REPLACEMENT

1. THE CONTRACTOR SHALL POSSESS THE LICENSE(S) REQUIRED IN THE INVITATION TO BID & SPECIAL PROVISIONS.
2. ALL MATERIAL AND WORK SHALL CONFORM TO STANISLAUS COUNTY SPECIFICATIONS AND IMPROVEMENT STANDARDS, 2014 EDITION, TO BE SUPPLEMENTED BY CALTRANS STANDARD PLANS, DATED MAY, 2010 AND STANDARD SPECIFICATIONS, DATED MAY, 2010; AND ALL CURRENT ADDENDA THERETO. ALL IMPROVEMENTS ARE SUBJECT TO THE INSPECTION AND APPROVAL OF THE PUBLIC WORKS DEPARTMENT.
3. THE CONTRACTOR SHALL TAKE PRECAUTIONARY MEASURES TO PROTECT ALL UTILITIES. THE CONTRACTOR SHALL DO NO EXCAVATION UNTIL ALL UTILITY AGENCIES AND THE STANISLAUS COUNTY DEPARTMENT OF PUBLIC WORKS HAVE BEEN NOTIFIED AND HAVE BEEN GIVEN THE OPPORTUNITY TO MARK THEIR FACILITIES IN THE FIELD. THE CONTRACTOR SHALL CALL U.S.A. AT LEAST FORTY-EIGHT (48) HOURS PRIOR TO DOING ANY EXCAVATING. THE CONTRACTOR SHALL POT HOLE SIGNAL CONDUIT CROSSINGS PRIOR TO FDR.
4. THESE PLANS HAVE BEEN CHECKED BY THE STANISLAUS COUNTY DEPARTMENT OF PUBLIC WORKS AND/OR AUTHORIZED REPRESENTATIVE, BUT SUCH CHECKING AND/OR APPROVAL DOES NOT RELIEVE THE CONTRACTOR FROM HIS/HER RESPONSIBILITY TO CORRECT ERRORS, OMISSIONS, OR MAKE CHANGES REQUIRED BY CONDITIONS DISCOVERED IN THE FIELD DURING COURSE OF CONSTRUCTION.
5. ALL CONSTRUCTION SITE ACTIVITIES SHALL CONFORM TO THE STATE WATER RESOURCES CONTROL BOARD, NATIONAL POLLUTION DISCHARGE ELIMINATION SYSTEM (NPDES), WASTE DISCHARGE REQUIREMENTS FOR DISCHARGES OF STORM WATER RUNOFF ASSOCIATED WITH CONSTRUCTION ACTIVITY.
6. PRIOR TO INITIATING ANY CONSTRUCTION, THE CONTRACTOR SHALL VERIFY THAT ALL NECESSARY FEDERAL, STATE, AND LOCAL PERMITS HAVE BEEN OBTAINED.
7. CONTACT:

STANISLAUS COUNTY, DEPARTMENT OF PUBLIC WORKS
JAMES DE JONG (209) 525-4113

APPROVED BY STANISLAUS COUNTY DEPARTMENT OF PUBLIC WORKS

MATT MACHADO, PE
DIRECTOR OF PUBLIC WORKS
STANISLAUS COUNTY

STANISLAUS COUNTY
DEPARTMENT OF PUBLIC WORKS
ENGINEERING AND OPERATIONS DIVISION
1716 MORGAN ROAD - MODESTO, CA 95358



COVER SHEET
IMPROVEMENT PLANS FOR:
RSTP PHASE I
FEDERAL AID PROJECT NO. 5938(236)
STANISLAUS COUNTY, CA

JOB NO 9473
DATE 3/28/2017
DR BY JDM
CK BY NT
SCALE AS SHOWN



SHEET NUMBER
1
OF 10 SHEETS

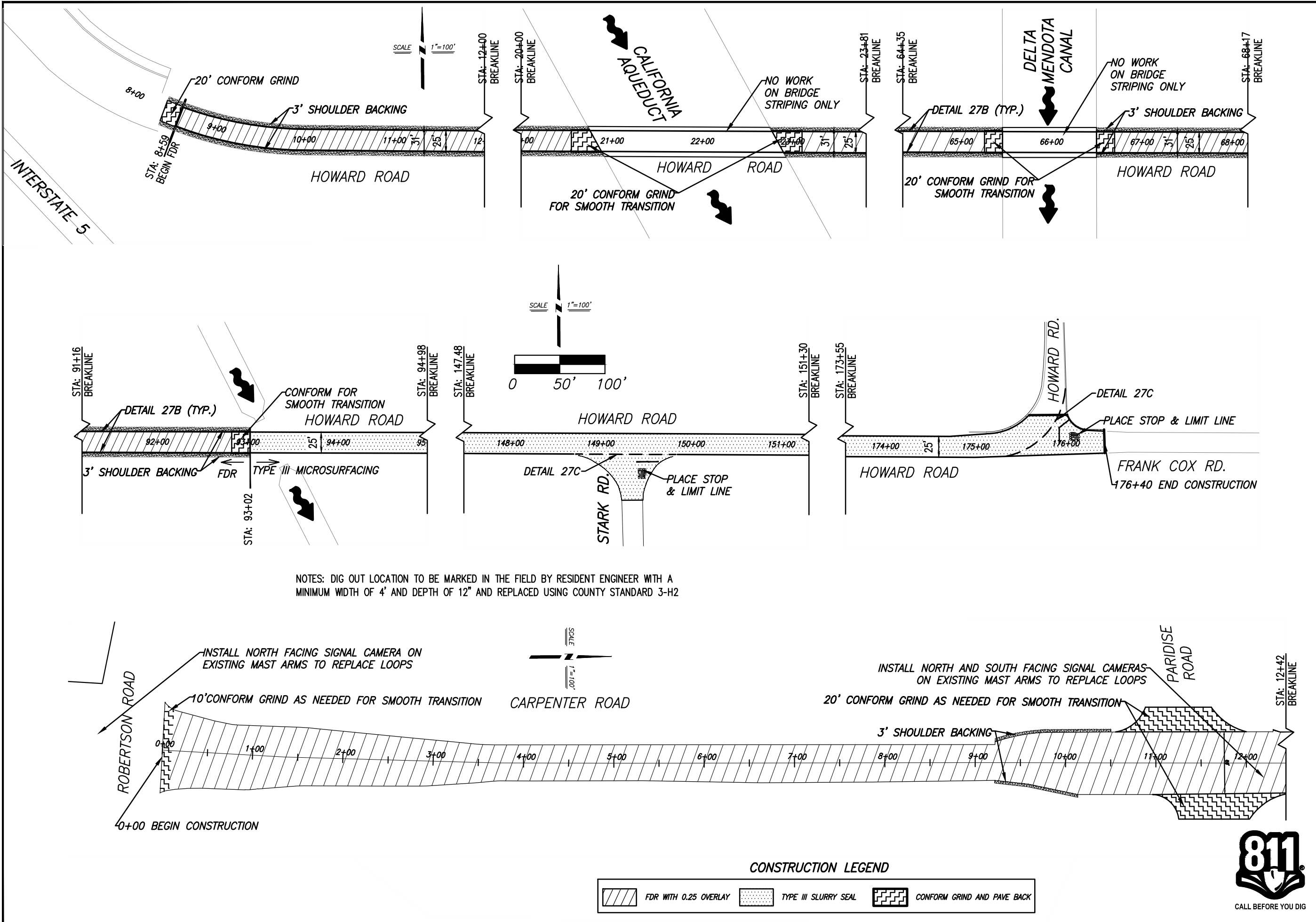

NOTES: DIG OUT LOCATION TO BE MARKED IN THE FIELD BY RESIDENT ENGINEER WITH A MINIMUM WIDTH OF 4' AND DEPTH OF 12" AND REPLACED USING COUNTY STANDARD 3-H2

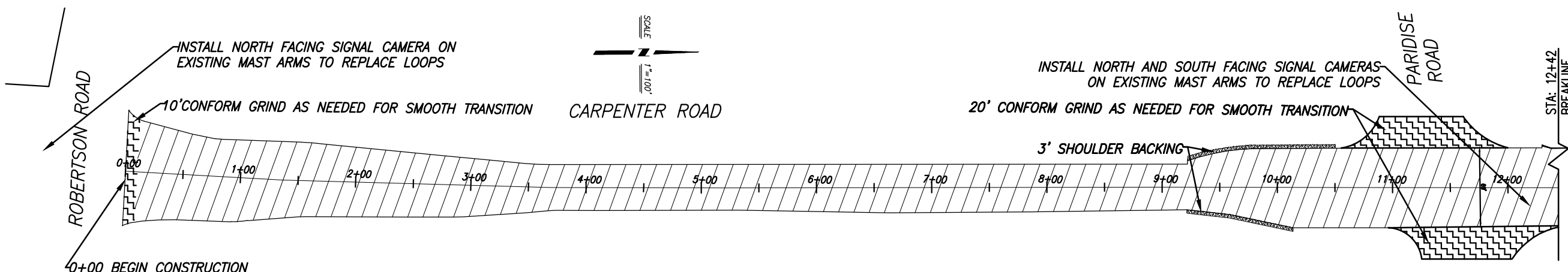

CONSTRUCTION LEGEND

- FDR WITH 0.25 OVERLAY
- TYPE III SLURRY SEAL
- CONFORM GRIND AND PAVE BACK



NO	DESCRIPTIONS	DATE	APPROVED

STANISLAUS COUNTY
 DEPARTMENT OF PUBLIC WORKS
 ENGINEERING AND OPERATIONS DIVISION
 1716 MORGAN ROAD - MODESTO, CA 95358

HOWARD RD. & CARPENTER RD.
 IMPROVEMENT PLANS FOR:
 RSTP PHASE L
 FEDERAL AID PROJECT NO. 5938(236)
 STANISLAUS COUNTY, CA

JOB NO 9473
 DATE 3/28/2017
 DR BY JDJ
 CK BY NT
 SCALE AS SHOWN

SHEET NUMBER
2
 OF 10 SHEETS

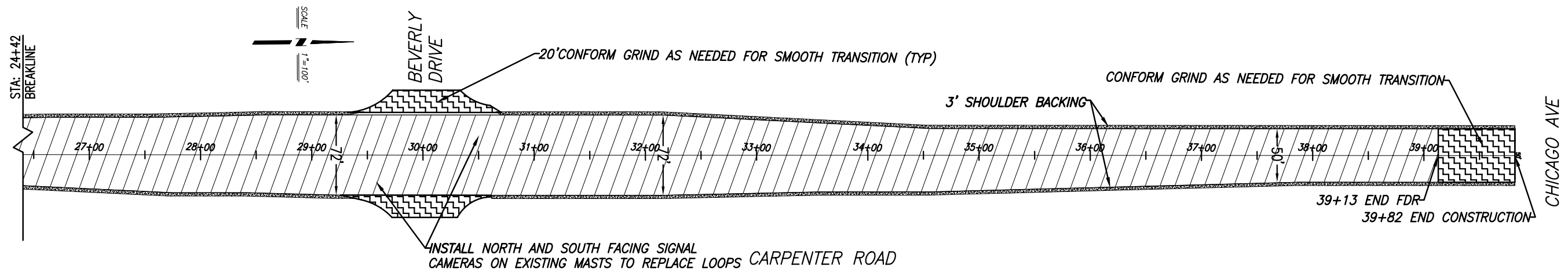
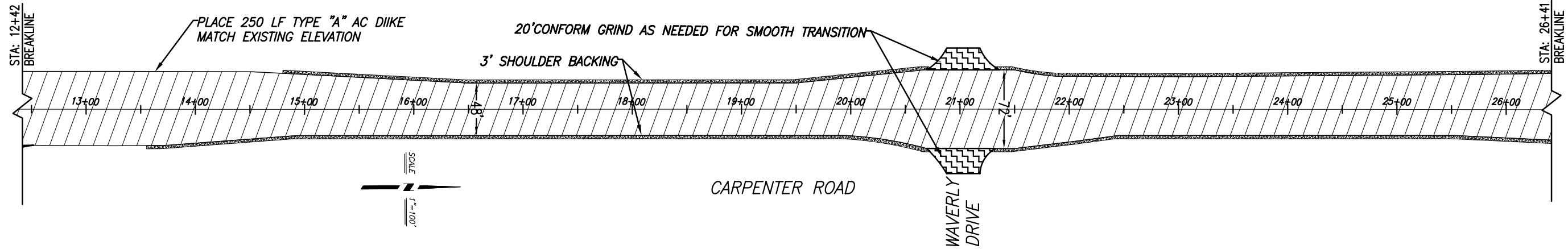

CONSTRUCTION LEGEND

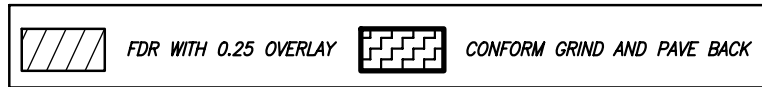

NO.	DESCRIPTIONS	DATE	APPROVED

STANISLAUS COUNTY
 DEPARTMENT OF PUBLIC WORKS
 ENGINEERING AND OPERATIONS DIVISION
 1716 MORGAN ROAD - MODESTO, CA 95358



CARPENTER RD.
 IMPROVEMENT PLANS FOR
 RSTP PHASE I
 FEDERAL AID PROJECT NO. 5938(236)
 STANISLAUS COUNTY, CA

JOB NO 9423
 DATE 3/28/2017
 DR BY DJT
 CK BY NT
 SCALE AS SHOWN



SHEET NUMBER
3
 OF 10 SHEETS

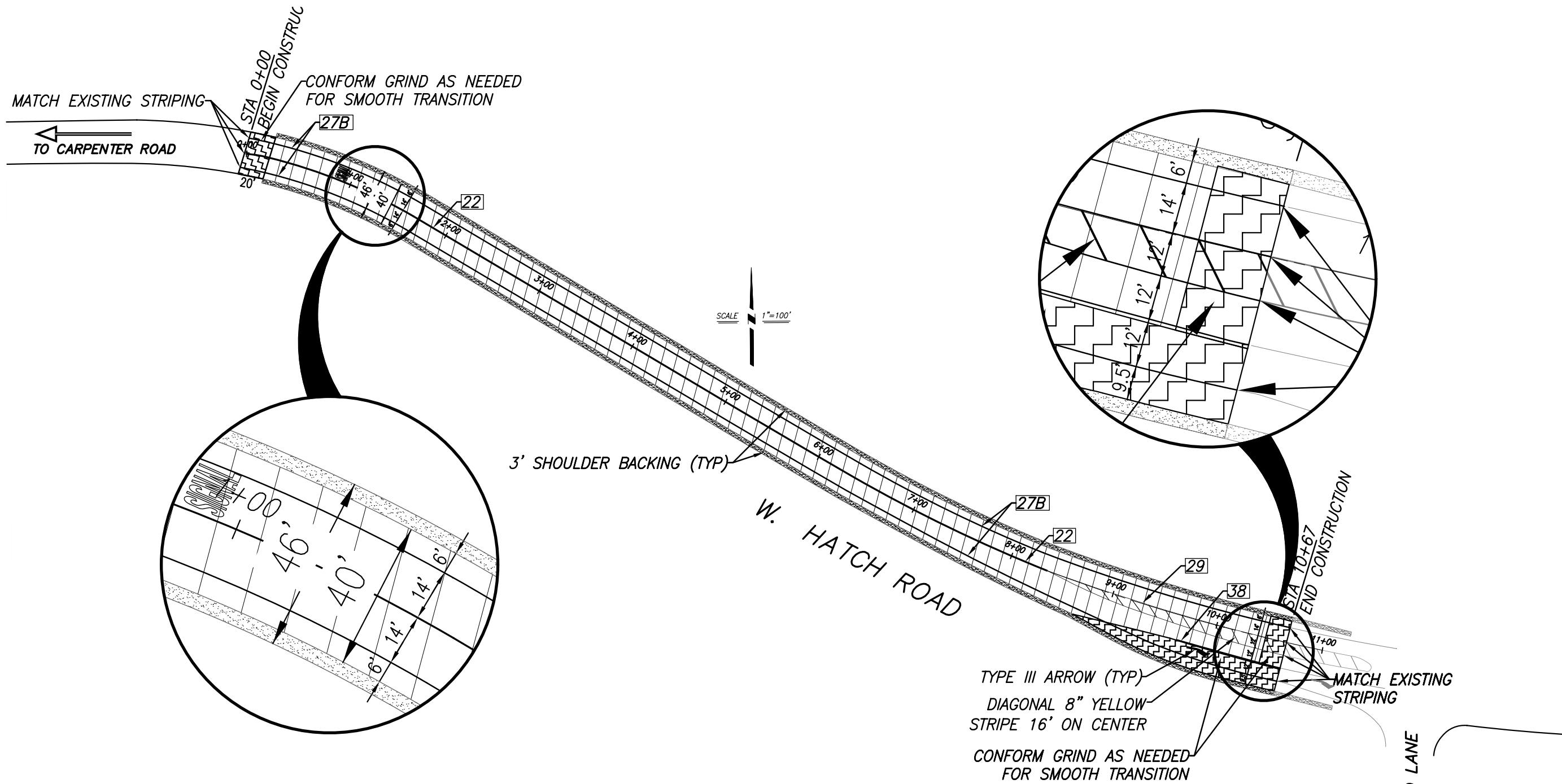

NOTE:
FOR A SMOOTH TRANSITION ROADWAY EXCAVATION SHALL BE DONE AFTER INITIAL F.D.R. & PRIOR TO H.M.A.

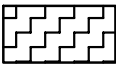
CONSTRUCTION LEGEND	
	12" FDR WITH 0.25' OVERLAY
	CONFORM GRIND



NO.	REVISIONS	DATE	APPROVED

STANISLAUS COUNTY
DEPARTMENT OF PUBLIC WORKS
ENGINEERING AND OPERATIONS DIVISION
1776 MORGAN ROAD - MODESTO, CA 95358



W. HATCH ROAD
IMPROVEMENT PLANS FOR:
RSTIP PHASE L
FEDERAL AID PROJECT NO. 5938(236)
STANISLAUS COUNTY, CA

JOB NO 9473
DATE 3/28/2017
DR BY JLI
CK BY NT
SCALE AS SHOWN



SHEET NUMBER
4
OF 10 SHEETS

- NOTES:
- 1 - FOR DETAILS NOT SHOWN ON PLANS, SEE THE MOST RECENT CALTRANS STD. A88A CURB RAMPS
 - 2 - CONTRACTOR RESPONSIBLE TO ENSURE ALL ADA REQUIRED SLOPES CALLED OUT ON THE PLANS ARE ADHERED TO, THE ELEVATIONS AND DIMENSIONS SHOWN ON THE PLANS ARE TO ASSIST WITH DESIGN AND FIELD ADJUSTMENT MAY BE NEEDED
 - 3 - PROVIDE A 4' LANDING FOR THE FULL WIDTH OF ALL RAMPS WITH 1.5% MAX SLOPE IN ALL DIRECTIONS
 - 4 - SAWCUT LINES SHOWN MAY NEED TO BE RELOCATED TO GET REQUIRED SLOPES AND SHOULD FOLLOW EXISTING DEEP JOINTS WHERE APPLICABLE
 - 5 - HMA REMOVED FOR RAMP CONSTRUCTION TO BE REPLACED INCLUDING ANY MARKINGS
 - 6 - PROTECT IN PLACE EXISTING DRAINAGE INLETS, TRAFFIC SIGNAL POLES, AND PULL BOXES

PARADISE ROAD

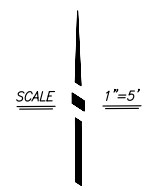

CARPENTER ROAD



NE CORNER

SW CORNER

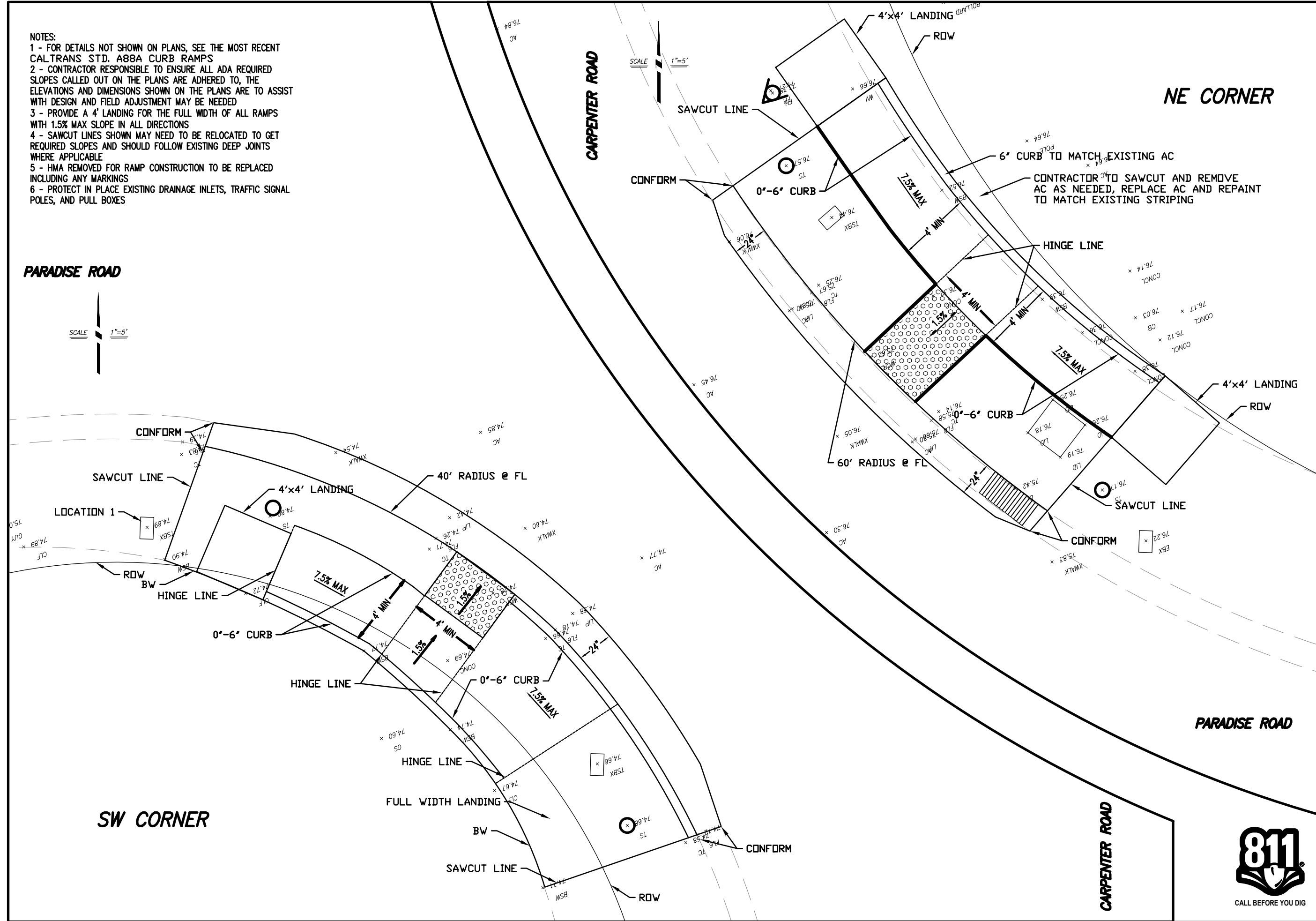

NO.	REVISIONS	DATE	APPROVED

STANISLAUS COUNTY
 DEPARTMENT OF PUBLIC WORKS
 ENGINEERING AND OPERATIONS DIVISION
 1716 MORGAN ROAD - MODESTO, CA 95358



PARADISE & CARPENTER ROAD INTERSECTION
 ADA IMPROVEMENTS NE & SW CORNERS
 IMPROVEMENT PLANS FOR:
 RSTIP PHASE I
 FEDERAL AID PROJECT NO. 5938(236)
 STANISLAUS COUNTY, CA

JOB NO 9473
 DATE 3/28/2017
 DR BY JDL
 CK BY NT
 SCALE AS SHOWN

SHEET NUMBER
5
 OF 10 SHEETS



SE CORNER

CARPENTER ROAD

PARADISE ROAD

CARPENTER ROAD



NO.	DESCRIPTIONS	DATE	APPROVED

STANISLAUS COUNTY
 DEPARTMENT OF PUBLIC WORKS
 ENGINEERING AND OPERATIONS DIVISION
 1716 MORGAN ROAD - MODESTO, CA 95358



PARADISE & CARPENTER ROAD INTERSECTION
 ADA IMPROVEMENTS NW & SE CORNERS
 IMPROVEMENT PLANS FOR:
 RSTIP PHASE L
 FEDERAL AID PROJECT NO. 5938(236)
 STANISLAUS COUNTY, CA

JOB NO 9473
 DATE 3/28/2017
 DR BY JLN
 CK BY NT
 SCALE AS SHOWN

SHEET NUMBER
6
 OF 10 SHEETS

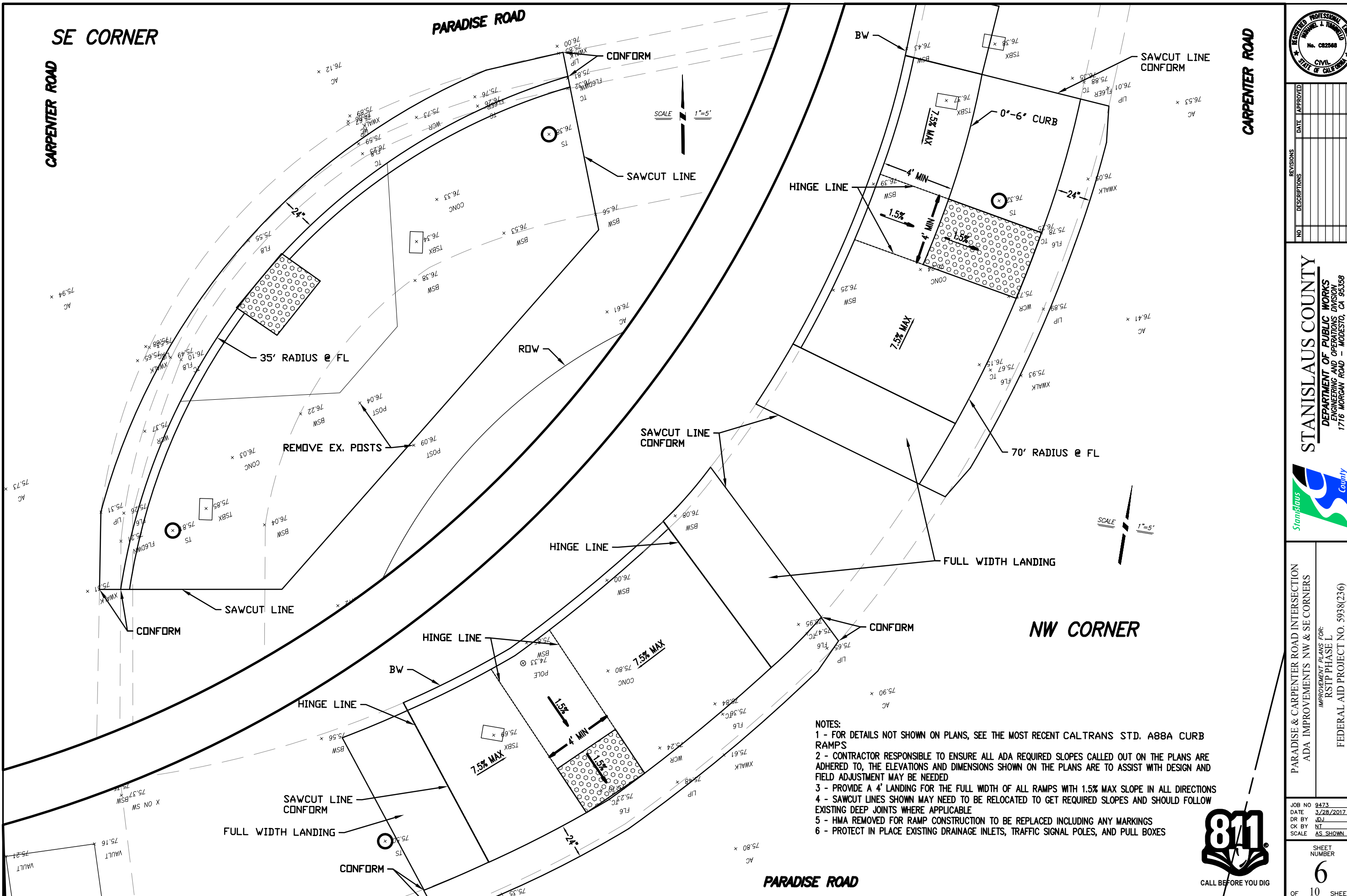

- NOTES:**
- 1 - FOR DETAILS NOT SHOWN ON PLANS, SEE THE MOST RECENT CALTRANS STD. A88A CURB RAMP
 - 2 - CONTRACTOR RESPONSIBLE TO ENSURE ALL ADA REQUIRED SLOPES CALLED OUT ON THE PLANS ARE ADHERED TO, THE ELEVATIONS AND DIMENSIONS SHOWN ON THE PLANS ARE TO ASSIST WITH DESIGN AND FIELD ADJUSTMENT MAY BE NEEDED
 - 3 - PROVIDE A 4' LANDING FOR THE FULL WIDTH OF ALL RAMP WITH 1.5% MAX SLOPE IN ALL DIRECTIONS
 - 4 - SAWCUT LINES SHOWN MAY NEED TO BE RELOCATED TO GET REQUIRED SLOPES AND SHOULD FOLLOW EXISTING DEEP JOINTS WHERE APPLICABLE
 - 5 - HMA REMOVED FOR RAMP CONSTRUCTION TO BE REPLACED INCLUDING ANY MARKINGS
 - 6 - PROTECT IN PLACE EXISTING DRAINAGE INLETS, TRAFFIC SIGNAL POLES, AND PULL BOXES



CARPENTER ROAD



NO.	REVISIONS	DATE	APPROVED

STANISLAUS COUNTY
 DEPARTMENT OF PUBLIC WORKS
 OPERATIONS AND MAINTENANCE DIVISION
 1716 MORGAN ROAD - MODESTO, CA 95358



CARPENTER ROAD STRIPING PLAN
 IMPROVEMENT PLANS FOR:
 RSTIP PHASE L
 FEDERAL AID PROJECT NO. 5938(236)
 STANISLAUS COUNTY, CA

JOB NO 9423
 DATE 3/28/2017
 DR BY JDL
 CK BY NT
 SCALE AS SHOWN

SHEET NUMBER
7
 OF 10 SHEETS

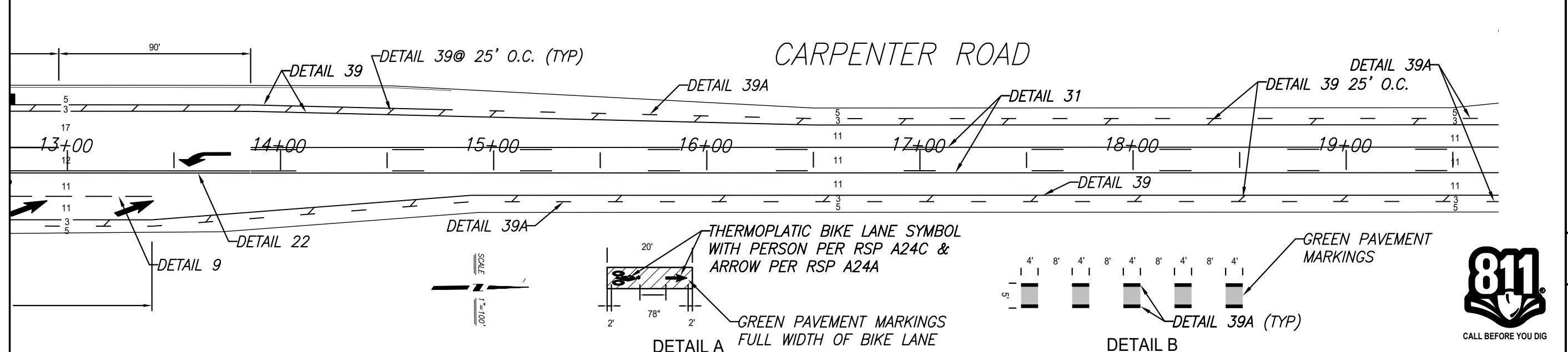
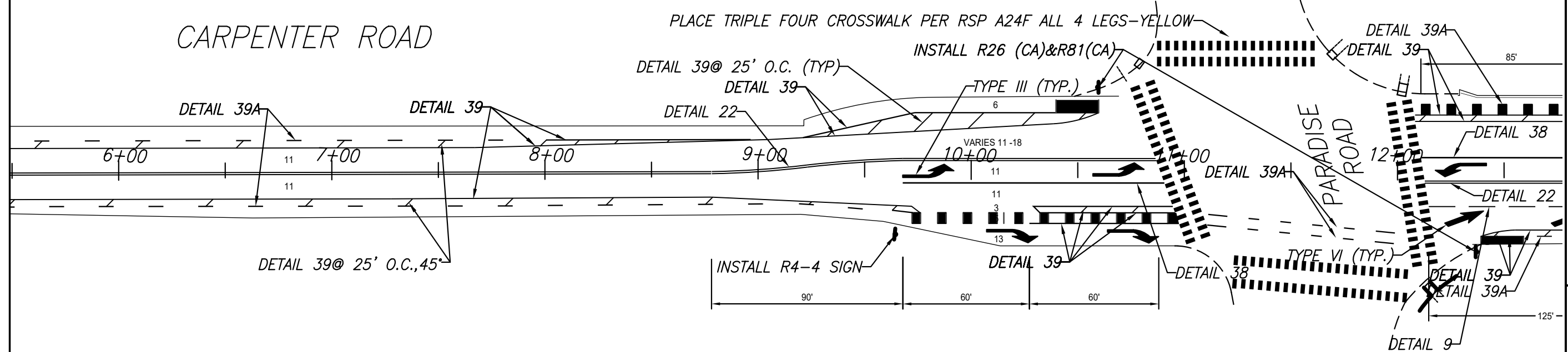
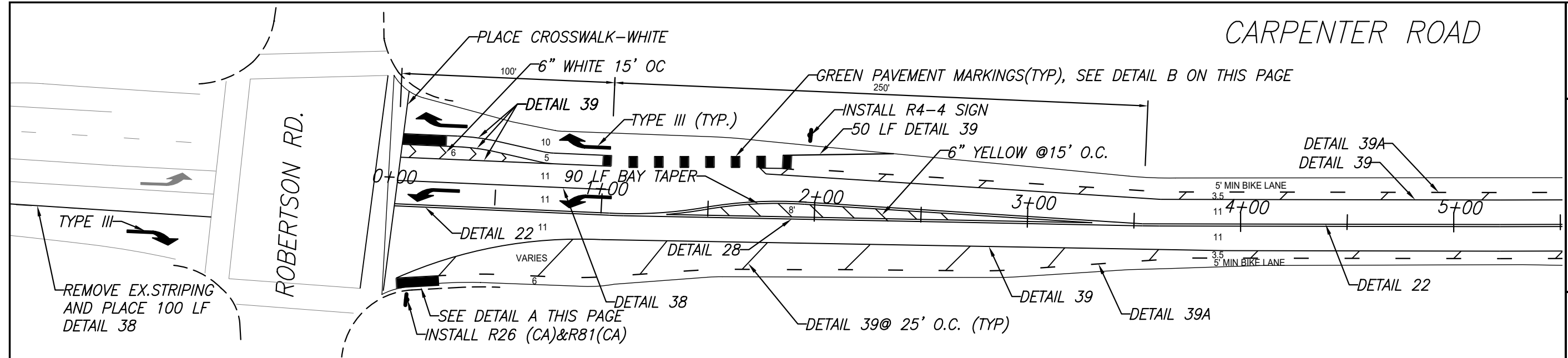

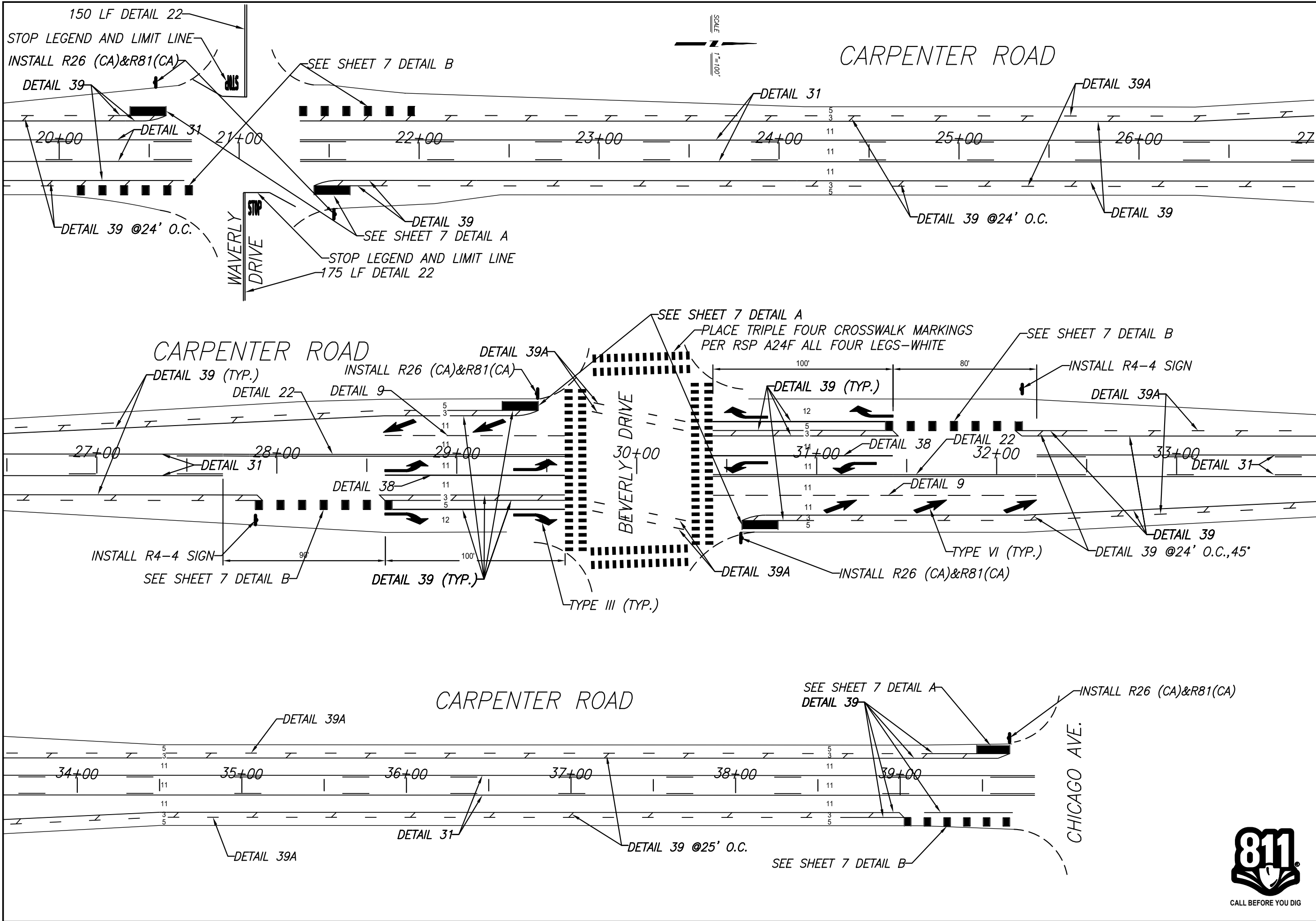

NO.	DESCRIPTIONS	DATE	APPROVED

STANISLAUS COUNTY
DEPARTMENT OF PUBLIC WORKS
ENGINEERING AND OPERATIONS DIVISION
1716 MORGAN ROAD - MODESTO, CA 95358



CARPENTER ROAD STRIPING PLAN
IMPROVEMENT PLANS FOR:
RSTIP PHASE L
FEDERAL AID PROJECT NO. 5938(236)
STANISLAUS COUNTY, CA

JOB NO 9473
DATE 3/28/2017
DR BY JDL
CK BY NT
SCALE AS SHOWN

SHEET NUMBER
8
OF 10 SHEETS



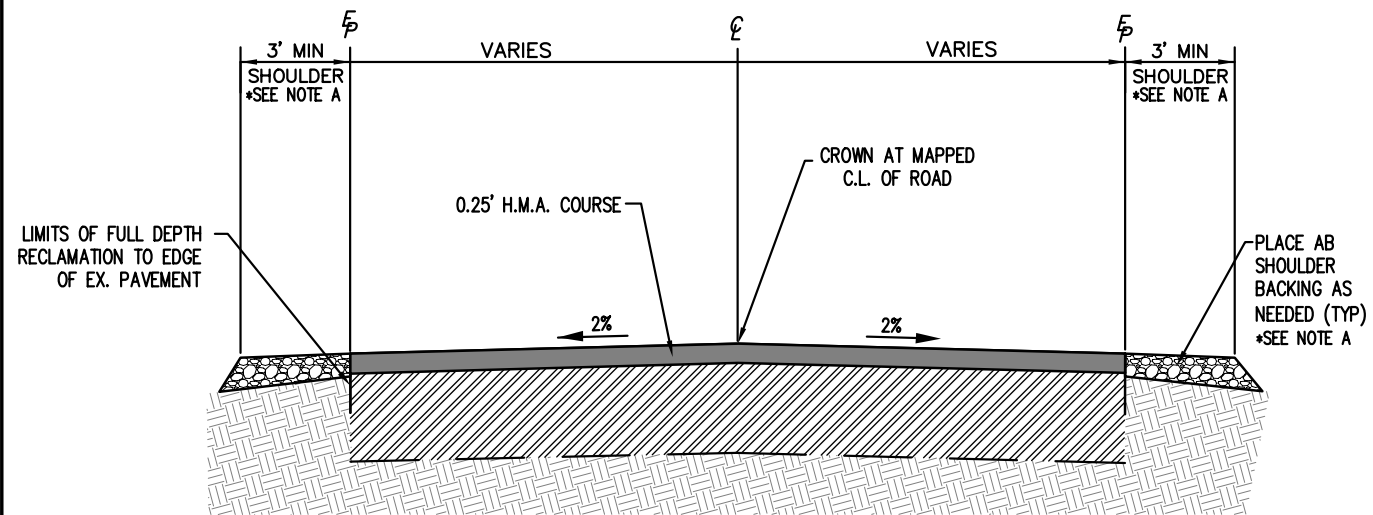

NOTE A:

- FOR A FINISHED ROADWAY WITH 2% CROSS SLOPE AND MAX SLOPE PROFILE GRADE, CONTRACTOR SHALL EXCAVATE AND TRIM AFTER INITIAL PULVERIZATION TO A DEPTH FOR NEW H.M.A. ($\pm 3"$) TO CONFORM WITH EXISTING CONCRETE GUTTER,
- PER RESIDENT ENGINEER'S DISCRETION TRIMMINGS MAY BE USED FOR SHOULDER BACKING
- THE ALGEBRAIC DIFFERENCE IN LONGITUDINAL GRADES SHALL NOT EXCEED 0.5%
- GRADE BREAKS SHALL NOT BE CLOSER TOGETHER THAN 50' AND A TOTAL OF ALL GRADE BREAKS WITHIN 200' SHALL NOT EXCEED 0.5%

FULL DEPTH RECLAMATION- CEMENT DETAIL

NTS

FDR & PAVEMENT DETAILS					
ROAD	FDR DEPTH	% PORTLAND CEMENT	OPTIMUM MOISTURE %	UNIT WEIGHT (lb/ft ³)	H.M.A. COURSE
HOWARD ROAD	1.5'	5%	18.0%	104.0	0.25'
WEST HATCH ROAD	1.0'	5%	7.1%	127.9	0.25'
CARPENTER ROAD	1.0'	5%	7.1%	125.0	0.25'

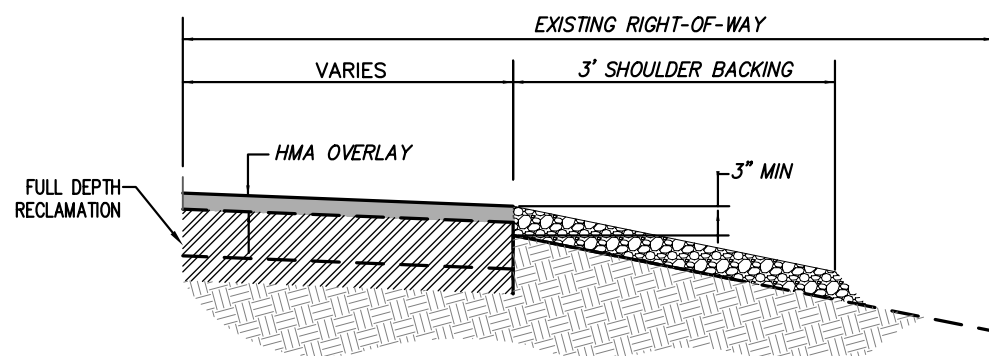

TYPICAL SHOULDER DETAIL

NTS

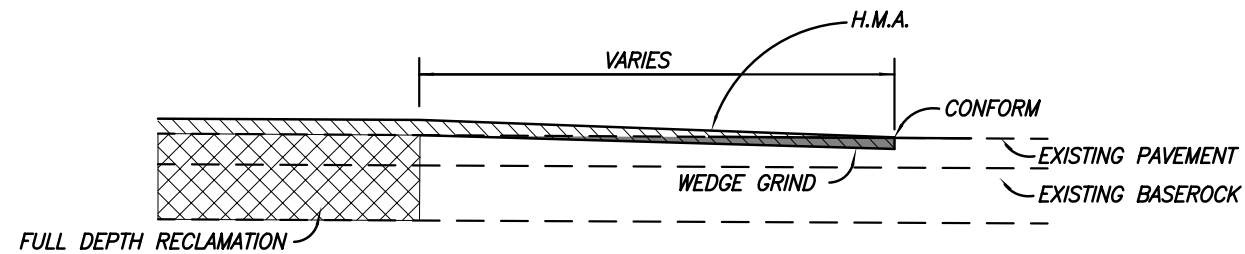

NOTE: MAX SLOPE GRADE CHANGE $\frac{1}{2}\%$ TO EXISTING PAVEMENTS FOR SMOOTH TRANSITIONS

CONFORM GRIND TRANSITION DETAIL

NTS

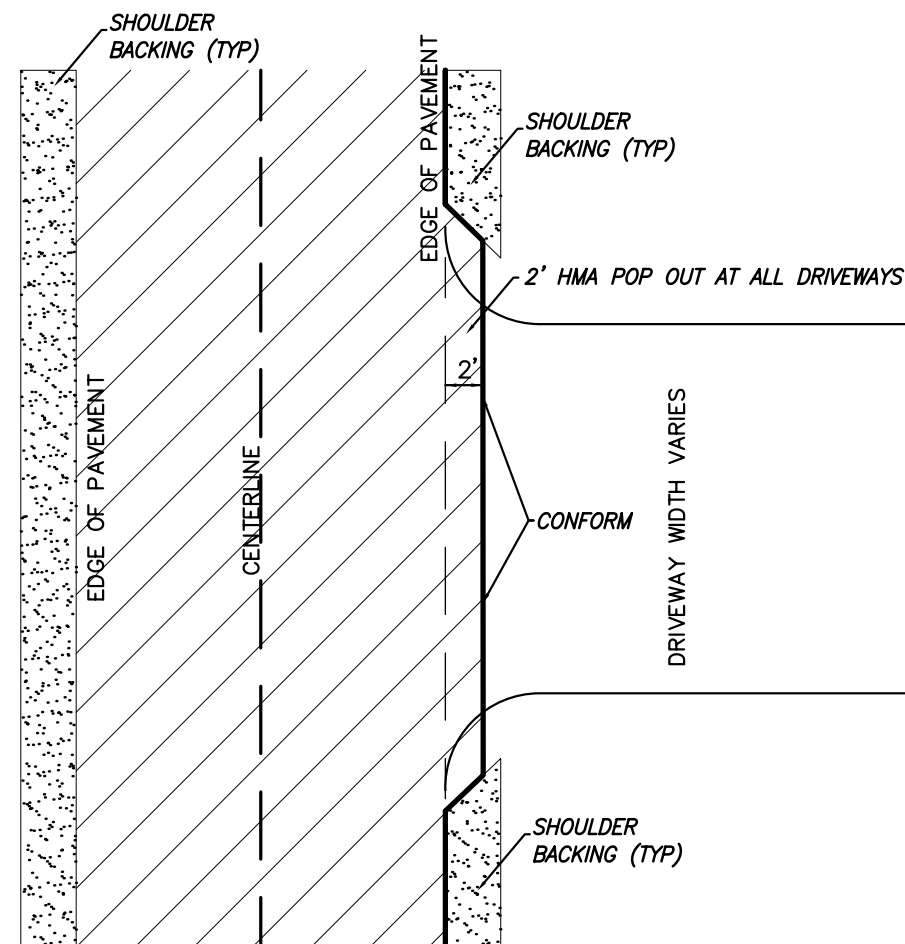

TYPICAL HMA DRIVEWAY WING OUT

NTS



NO.	DESCRIPTIONS	DATE	APPROVED

STANISLAUS COUNTY
DEPARTMENT OF PUBLIC WORKS
ENGINEERING AND OPERATIONS DIVISION
1716 MORGAN ROAD - MODESTO, CA 95358

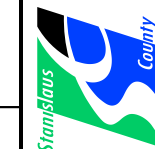

CONSTRUCTION DETAILS
IMPROVEMENT PLANS FOR:
RSTP PHASE L
FEDERAL AID PROJECT NO. 5938(236)
STANISLAUS COUNTY, CA

JOB NO 9473
DATE 3/28/2017
DR BY JBJ
CK BY NT
SCALE AS SHOWN

SHEET NUMBER
9
OF 10 SHEETS



STRIPING TYPE & LOCATIONS

HOWARD ROAD		DETAIL 6	DETAIL 19	DETAIL 22	DETAIL 27B & 27C	DETAIL 38	DETAIL 29	DETAIL 9	DETAIL 32	PAVEMENT MARKINGS
FROM	TO	LF	LF	LF	LF	LF	LF	LF	LF	SF
8+42	176+40				33596					
8+42	23+00			1458						
23+00	35+00		1200							
35+00	52+50	1750								
52+50	64+50		1200							
64+50	68+00			350						
68+00	80+00		1200							
80+00	143+66	6366								
143+66	149+16		550							
149+86	155+36		550							
155+36	163+20	784								
163+20	175+20		1200							
175+90	181+30		540							54
W HATCH ROAD										
0+00	8+35			835	1670					63
8+35	9+65				260		130			60
9+65	10+65				200	100	100			132
CARPENTER ROAD - SEE SHEETS 7 & 8 FOR STRIPING PLAN										

EXISTING MONUMENT LOCATIONS

HOWARD ROAD
 N 2018633.928, E 6357421.602, MONWELL
 N 2018647.800, E 6354764.375, MONWELL
 N 2018655.260, E 6352115.798, SPIKE
 N 2018665.525, E 6349463.184, PK NAIL
 N 2018665.817, E 6349446.169, HOLE IN PAVE
 N 2018675.386, E 6346811.524, PATCH
 N 2018685.929, E 6344155.495, MONWELL
 N 2018685.861, E 6344150.966, MONWELL
 N 2018686.366, E 6344006.975, MONWELL

CARPENTER ROAD
 N 2047232.409, E 6407407.117, SET SPIKE
 N 2047420.871, E 6407998.460, SET SPIKE
 N 2047509.376, E 6408037.051, 2"IP IN MW
 N 2046186.580, E 6408037.190, FD 3/4"IP LS6953 IN MW
 N 2046186.657, E 6408041.915, FD 3/4"IP LS6953 IN MW
 N 2046464.433, E 6408052.134, CONC MON IN MW
 N 2046260.720, E 6408046.216, CONC MON IN MW
 N 2046324.668, E 6408048.081, N+T
 N 2050145.421, E 6408037.267, 2"IP IN MW
 N 2050156.943, E 6408037.295, 2"IP IN MW

WEST HATCH ROAD
 N 2043774.37, E 6408885.68

Coordinates are based on the California Coordinate System NAD83
 Zone 3(Epoch 2010.00)

METERED SERVICE PEDESTAL REPLACEMENT AT CARPENTER & PARADISE

EXISTING SERVICE DEMO DETAIL

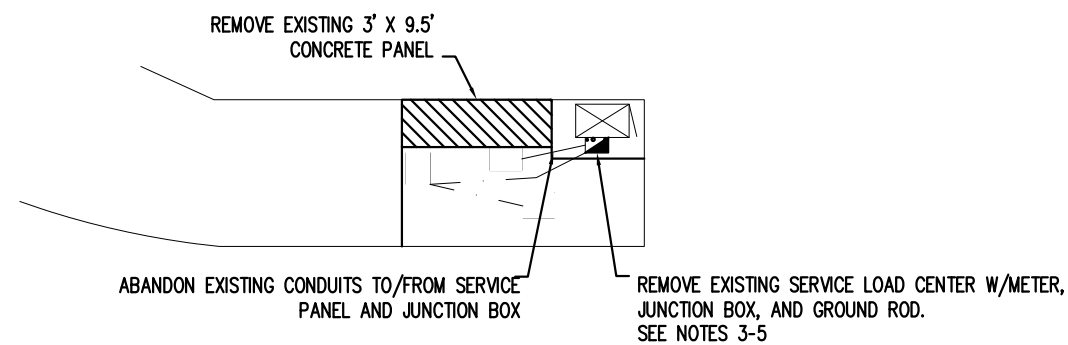

PROPOSED SERVICE DETAIL

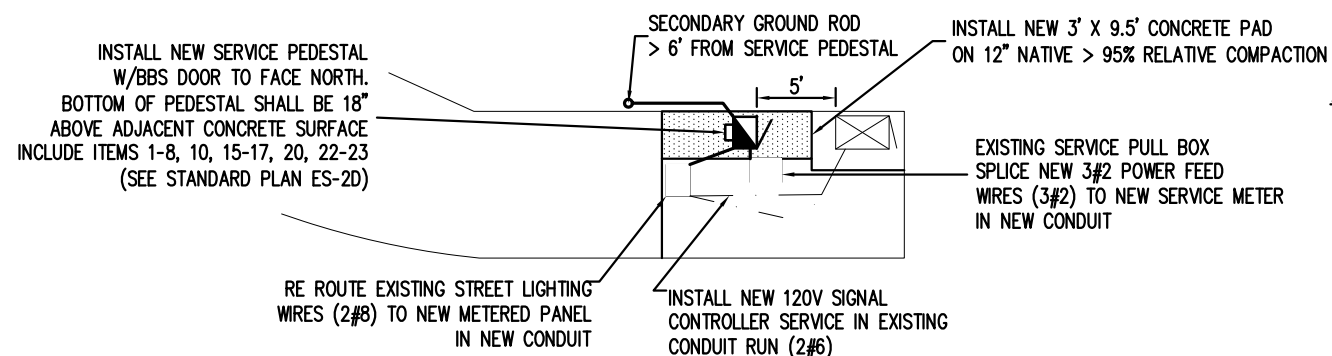

NOTES

- 1) ALL NEW CONCRETE WORK SHALL NOT EXCEED 1.50% SLOPE IN ANY DIRECTION
- 2) ALL NEW CONDUITS SHALL BE 2" SCHEDULE 40 PVC UNLESS OTHERWISE NOTED.
- 3) ALL EXISTING BOLT HOLES REMAINING FROM THE REMOVAL OF THE SERVICE AND JUNCTION BOX SHALL BE FILLED WITH A BOLT, FLAT WASHERS ON BOTH SIDES, LOCK WASHER, AND NUT WITH 100% SILICONE SEALANT IN THE APPROPRIATE SIZE.
- 4) GROUNDING ROD TO BE CUT AND/OR GROUND FLUSH WITH EXISTING CONCRETE.
- 5) WHERE ABANDONED CONDUITS EMERGE FROM CONCRETE, THE CONDUITS SHALL BE CUT AND/OR GROUND FLUSH WITH THE CONCRETE AND SEALED WITH FAST SET GROUT.
- 6) NEW GROUND ROD SHALL BE INSTALLED IN NEW ELECTRICAL SERVICE FOUNDATION AND A 1" PVC CONDUIT SHALL BE PROVIDED FROM ELECTRICAL SERVICE TO SECONDARY GROUND ROD LOCATION, NO CLOSER THAN 6'.



NO.	DESCRIPTIONS	DATE	APPROVED
1	RECEIVED STRIPING TYPE	4-15-17	DU

STANISLAUS COUNTY
 DEPARTMENT OF PUBLIC WORKS
 ENGINEERING AND OPERATIONS DIVISION
 1716 MORGAN ROAD - MODESTO, CA 95358



STRIPING PLAN, MONUMENT LOCATIONS &
 METERED SERVICE PEDESTAL REPLACEMENT
 IMPROVEMENT PLANS FOR:
 RSTP PHASE L
 FEDERAL AID PROJECT NO. 5938(236)
 STANISLAUS COUNTY, CA

JOB NO 9473
 DATE 3/28/2017
 DR BY DJJ
 CK BY NT
 SCALE AS SHOWN



SHEET NUMBER
10
 OF 10 SHEETS