

NO.	REVISIONS	DATE	APPROVED

STANISLAUS COUNTY  
 DEPARTMENT OF PUBLIC WORKS  
 ENGINEERING AND OPERATIONS DIVISION  
 1716 MORGAN ROAD - MODESTO, CA 95358



WARNERVILLE ROAD  
 STATION 0+00 TO 29+48  
 IMPROVEMENT PLANS FOR:  
 SB-1 ROADWAY RECONSTRUCTION PROJECT  
 BENTLEY ROAD & WARNERVILLE ROAD  
 STANISLAUS COUNTY, CA

JOB NO 9636  
 DATE 4/1/2018  
 DR BY JDI  
 CK BY NT  
 SCALE 1:50

SHEET NUMBER  
 2  
 OF 14 SHEETS







NO	DESCRIPTIONS	DATE	APPROVED

**STANISLAUS COUNTY**  
 DEPARTMENT OF PUBLIC WORKS  
 ENGINEERING AND OPERATIONS DIVISION  
 1716 MORGAN ROAD - MODESTO, CA 95358

**WARNERVILLE ROAD**  
 IMPROVEMENT PLANS FOR:  
 SB-1 ROADWAY RECONSTRUCTION PROJECT  
 BENTLEY ROAD & WARNERVILLE ROAD  
 STANISLAUS COUNTY, CA

JOB NO 9636  
 DATE 4/1/2018  
 DR BY JJC  
 CK BY NT  
 SCALE 1:50

SHEET NUMBER  
**3**  
 OF 14 SHEETS





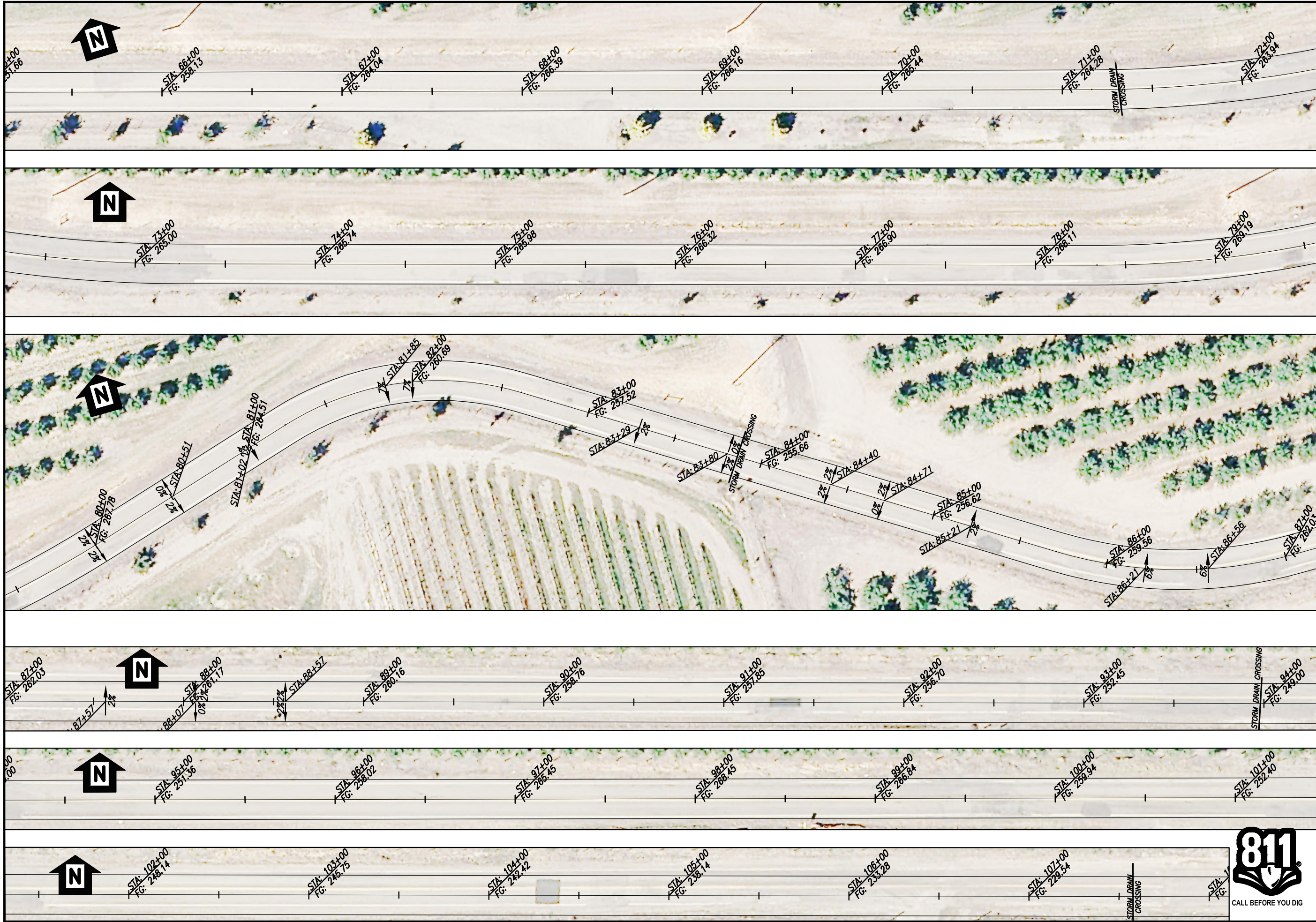

NO.	REVISIONS	DATE	APPROVED

STANISLAUS COUNTY  
 DEPARTMENT OF PUBLIC WORKS  
 ENGINEERING AND OPERATIONS DIVISION  
 1716 MORGAN ROAD - MODESTO, CA 95358



WARNERVILLE ROAD  
 STATION 65+26 TO 108+10  
 IMPROVEMENT PLANS FOR:  
 SB-1 ROADWAY RECONSTRUCTION PROJECT  
 BENTLEY ROAD & WARNERVILLE ROAD  
 STANISLAUS COUNTY, CA

JOB NO 9636  
 DATE 4/1/2018  
 DR BY JDI  
 CK BY NT  
 SCALE 1:50

SHEET NUMBER  
 4  
 OF 14 SHEETS





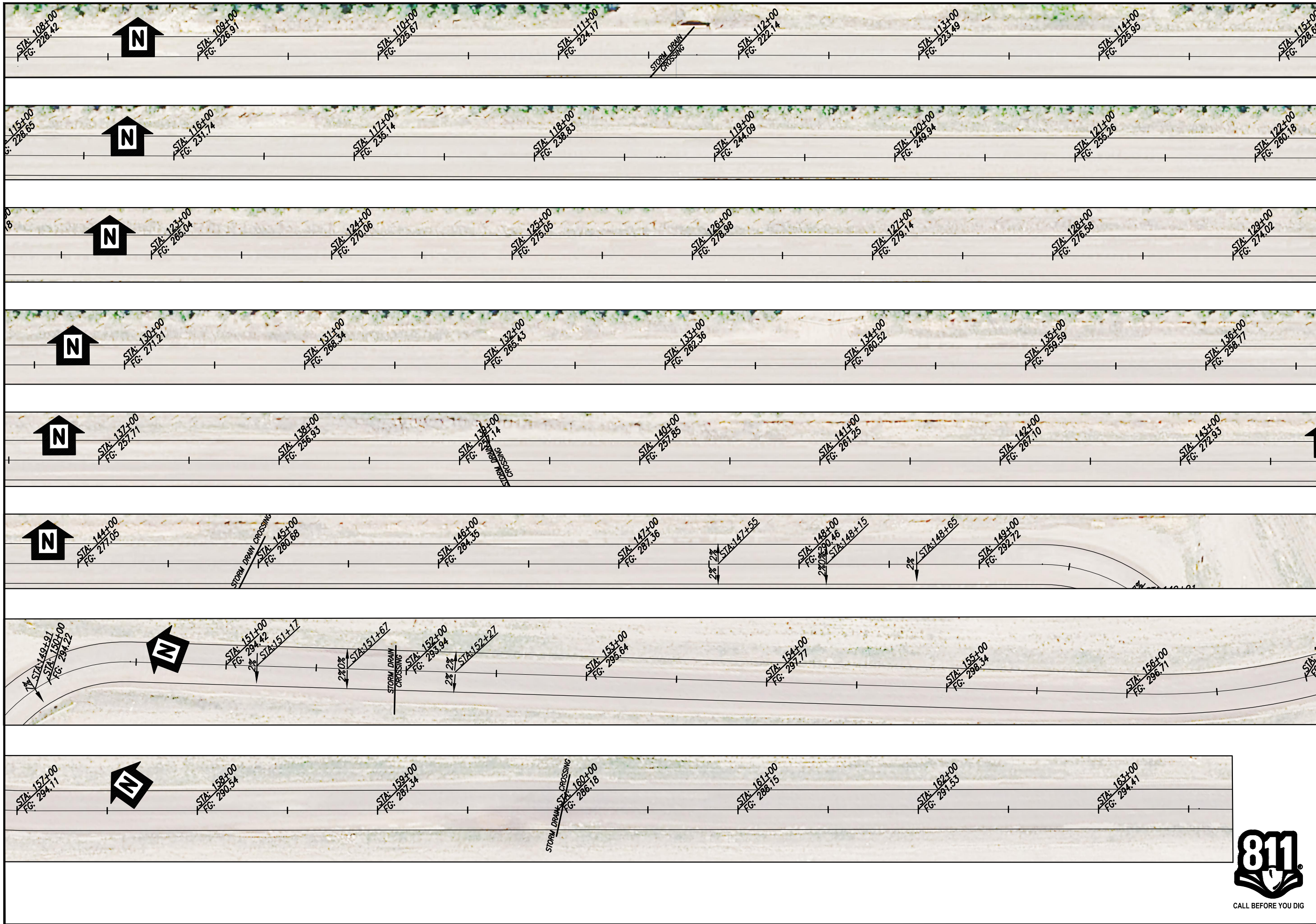

NO.	DESCRIPTIONS	DATE	APPROVED

STANISLAUS COUNTY  
 DEPARTMENT OF PUBLIC WORKS  
 ENGINEERING AND OPERATIONS DIVISION  
 1716 MORGAN ROAD - MODESTO, CA 95358

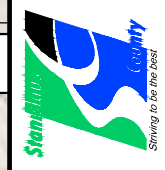

WARNERVILLE ROAD  
 STATION 108+10 TO 163+70  
 IMPROVEMENT PLANS FOR:  
 SB-1 ROADWAY RECONSTRUCTION PROJECT  
 BENTLEY ROAD & WARNERVILLE ROAD  
 STANISLAUS COUNTY, CA

JOB NO 9636  
 DATE 4/1/2018  
 DR BY JDI  
 CK BY NT  
 SCALE 1:50

SHEET NUMBER  
**5**  
 OF 14 SHEETS





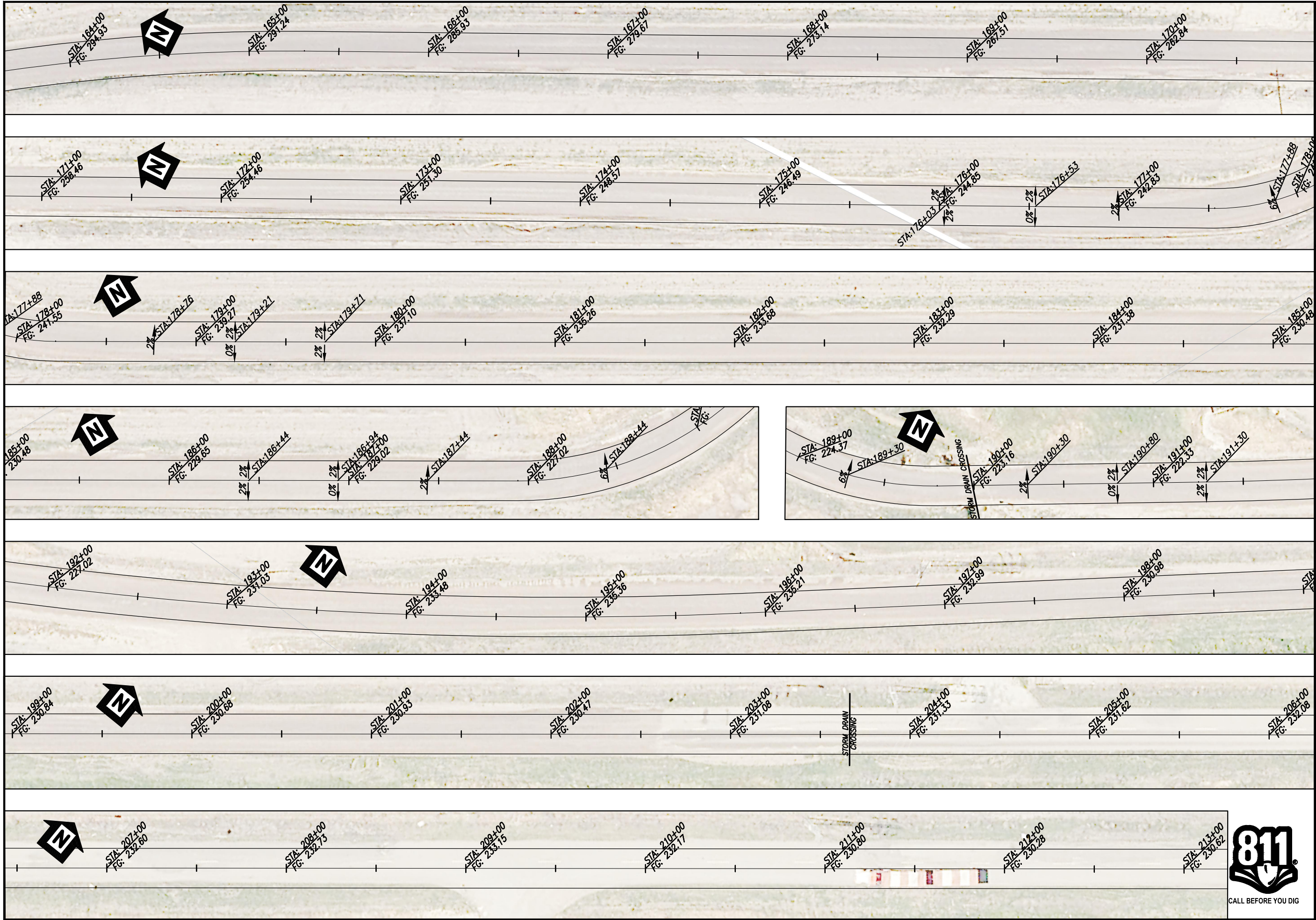

NO.	DESCRIPTIONS	DATE	APPROVED

**STANISLAUS COUNTY**  
 DEPARTMENT OF PUBLIC WORKS  
 ENGINEERING AND OPERATIONS DIVISION  
 1716 MORGAN ROAD - MODESTO, CA 95358



**WARNERVILLE ROAD**  
 STATION 163.70 TO 213+20  
 IMPROVEMENT PLANS FOR:  
 SB-1 ROADWAY RECONSTRUCTION PROJECT  
 BENTLEY ROAD & WARNERVILLE ROAD  
 STANISLAUS COUNTY, CA

JOB NO	9636
DATE	4/1/2018
DR BY	JDI
CK BY	NT
SCALE	1:50
SHEET NUMBER	6
OF 14 SHEETS	







NO.	REVISIONS	DATE	APPROVED

**STANISLAUS COUNTY**  
 DEPARTMENT OF PUBLIC WORKS  
 ENGINEERING AND OPERATIONS DIVISION  
 1716 MORGAN ROAD - MODESTO, CA 95358



**WARNERVILLE ROAD**  
 STATION 213+20 TO 248+96  
 IMPROVEMENT PLANS FOR:  
 SB-1 ROADWAY RECONSTRUCTION PROJECT  
 BENTLEY ROAD & WARNERVILLE ROAD  
 STANISLAUS COUNTY, CA

JOB NO	9636
DATE	4/1/2018
DR BY	JDI
CK BY	NT
SCALE	1:50
SHEET NUMBER	7
OF	14 SHEETS









CONFORM  
ID  
POSITION

SECTION  
SHEETS

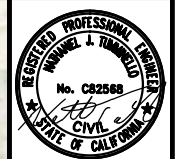
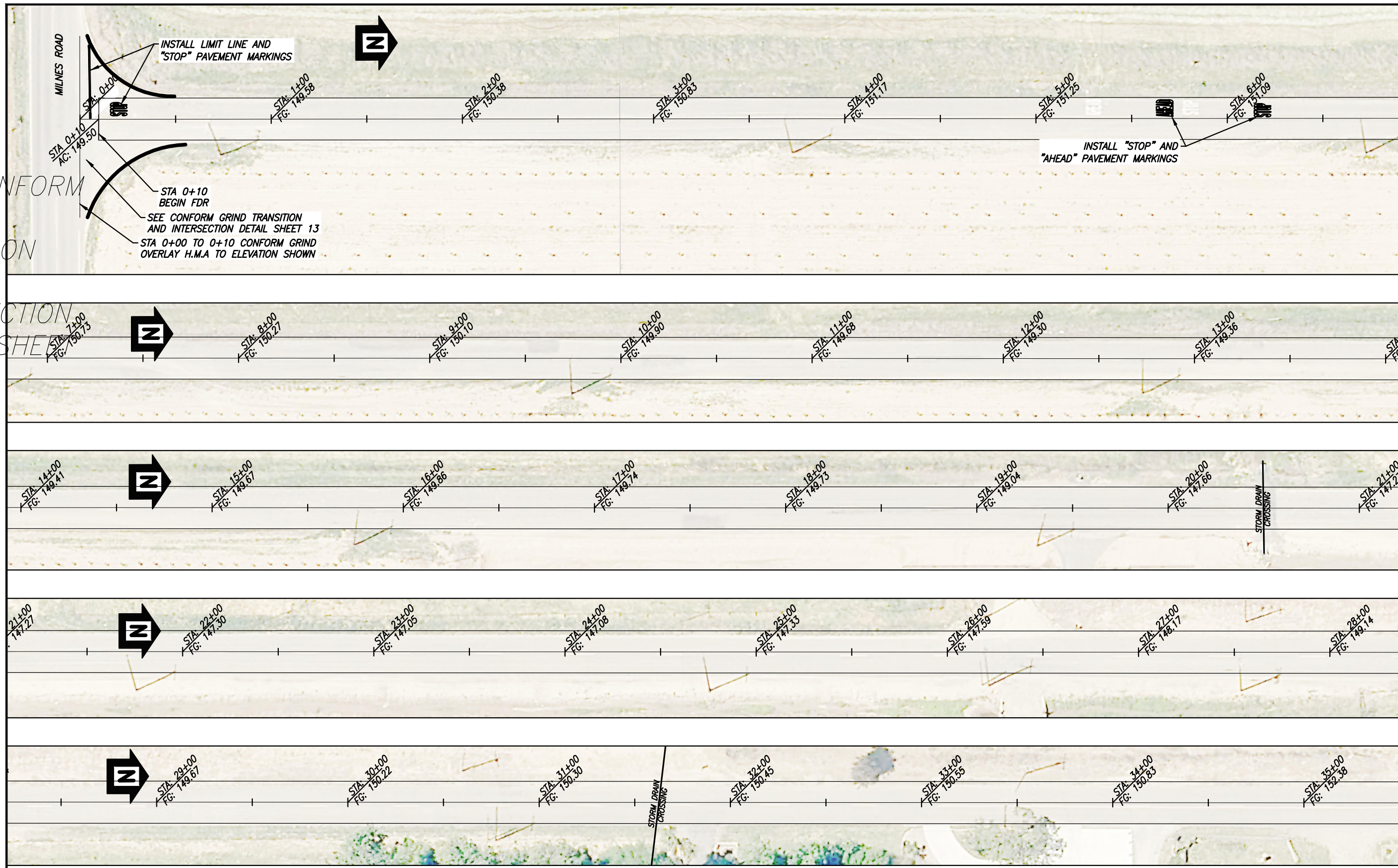

NO	REVISIONS	DATE	APPROVED

**STANISLAUS COUNTY**  
 DEPARTMENT OF PUBLIC WORKS  
 ENGINEERING AND OPERATIONS DIVISION  
 1716 MORGAN ROAD - MODESTO, CA 95358

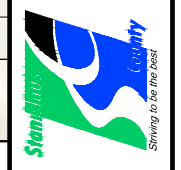

**BENTLEY ROAD**  
 STATION 0+00 TO 35+50  
 IMPROVEMENT PLANS FOR:  
 SB-1 ROADWAY RECONSTRUCTION PROJECT  
 BENTLEY ROAD & WARNERVILLE ROAD  
 STANISLAUS COUNTY, CA

JOB NO 9636  
 DATE 4/1/2018  
 DR BY JDI  
 CK BY NT  
 SCALE 1:50

SHEET NUMBER  
**9**  
 OF 14 SHEETS





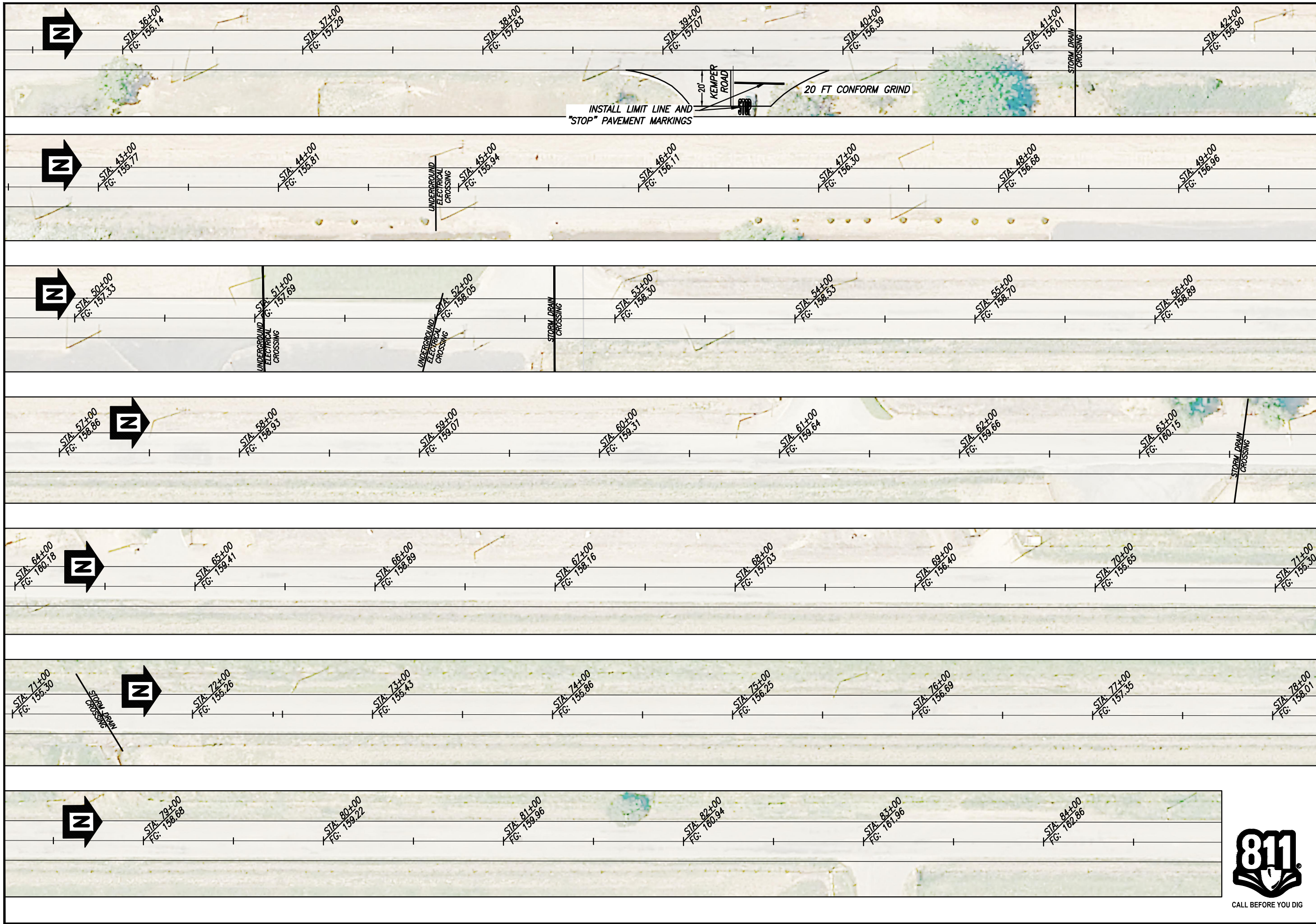

NO.	DESCRIPTIONS	DATE	APPROVED

**STANISLAUS COUNTY**  
 DEPARTMENT OF PUBLIC WORKS  
 ENGINEERING AND OPERATIONS DIVISION  
 1716 MORGAN ROAD - MODESTO, CA 95358



BENTLEY ROAD  
 STATION 35+00 TO 84+98  
 IMPROVEMENT PLANS FOR:  
 SB-1 ROADWAY RECONSTRUCTION PROJECT  
 BENTLEY ROAD & WARNERVILLE ROAD  
 STANISLAUS COUNTY, CA

JOB NO 9636  
 DATE 4/1/2018  
 DR BY JDI  
 CK BY NT  
 SCALE 1:50

SHEET NUMBER  
**10**  
 OF 14 SHEETS









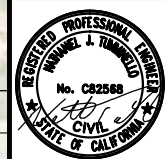

NO.	DESCRIPTIONS	DATE	APPROVED

**STANISLAUS COUNTY**  
 DEPARTMENT OF PUBLIC WORKS  
 ENGINEERING AND OPERATIONS DIVISION  
 1716 MORGAN ROAD - MODESTO, CA 95358

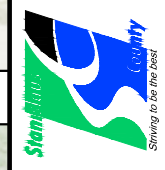

**BENTLEY ROAD**  
 STATION 133+96 TO 183+58  
 IMPROVEMENT PLANS FOR:  
 SB-1 ROADWAY RECONSTRUCTION PROJECT  
 BENTLEY ROAD & WARNERVILLE ROAD  
 STANISLAUS COUNTY, CA

JOB NO	9636
DATE	4/1/2018
DR BY	JDJ
CK BY	NT
SCALE	1:50

SHEET NUMBER  
**12**  
 OF 14 SHEETS

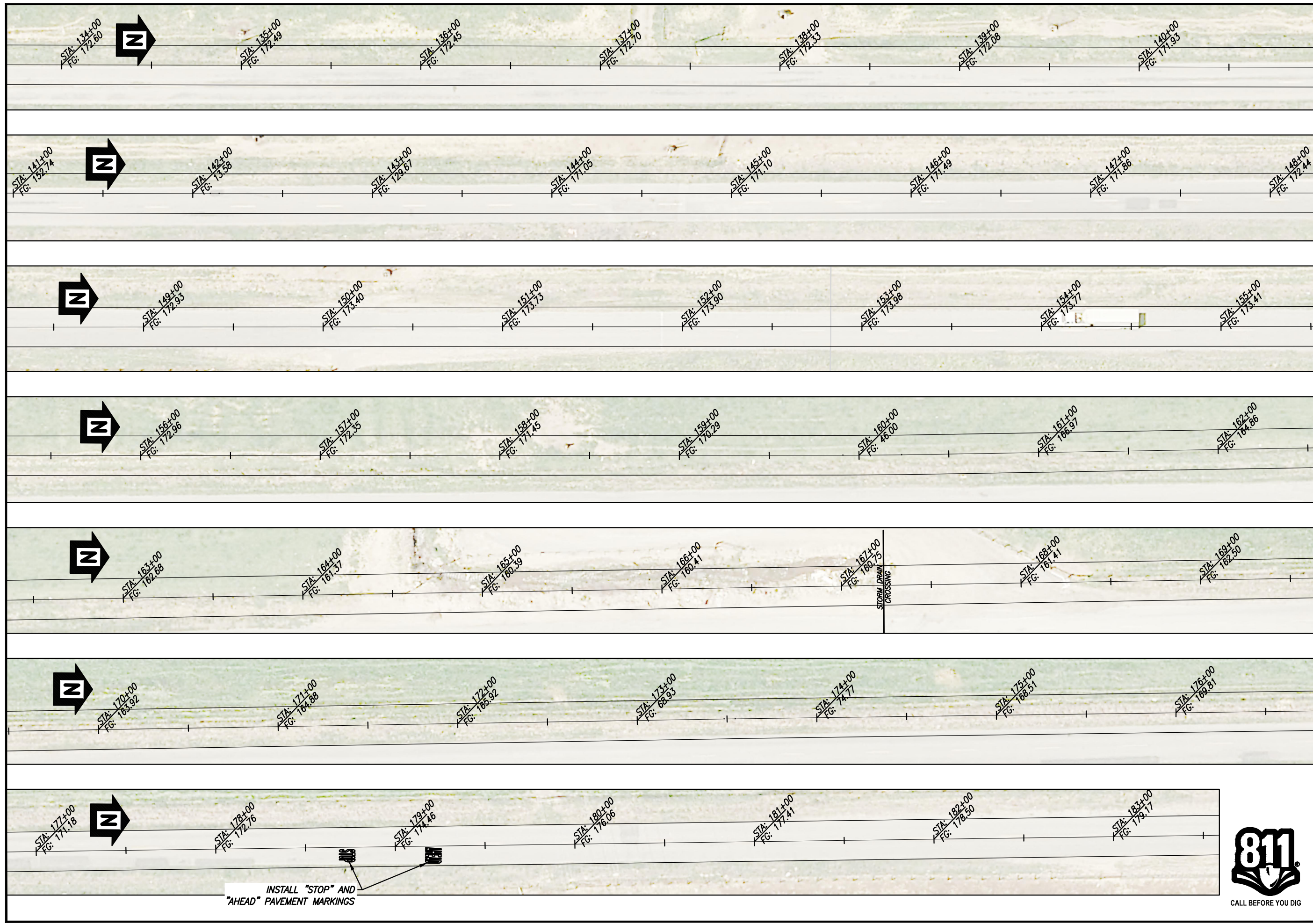



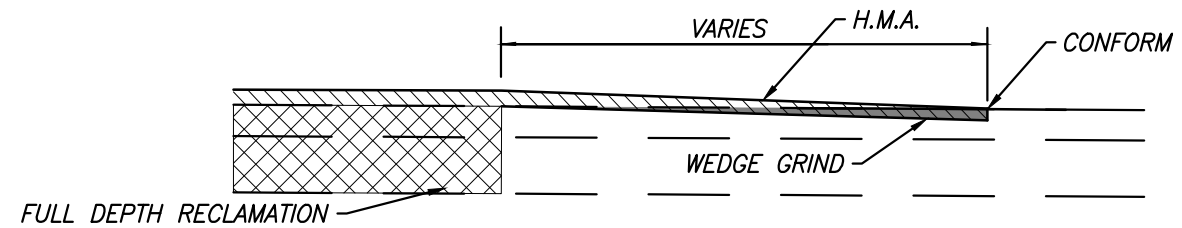
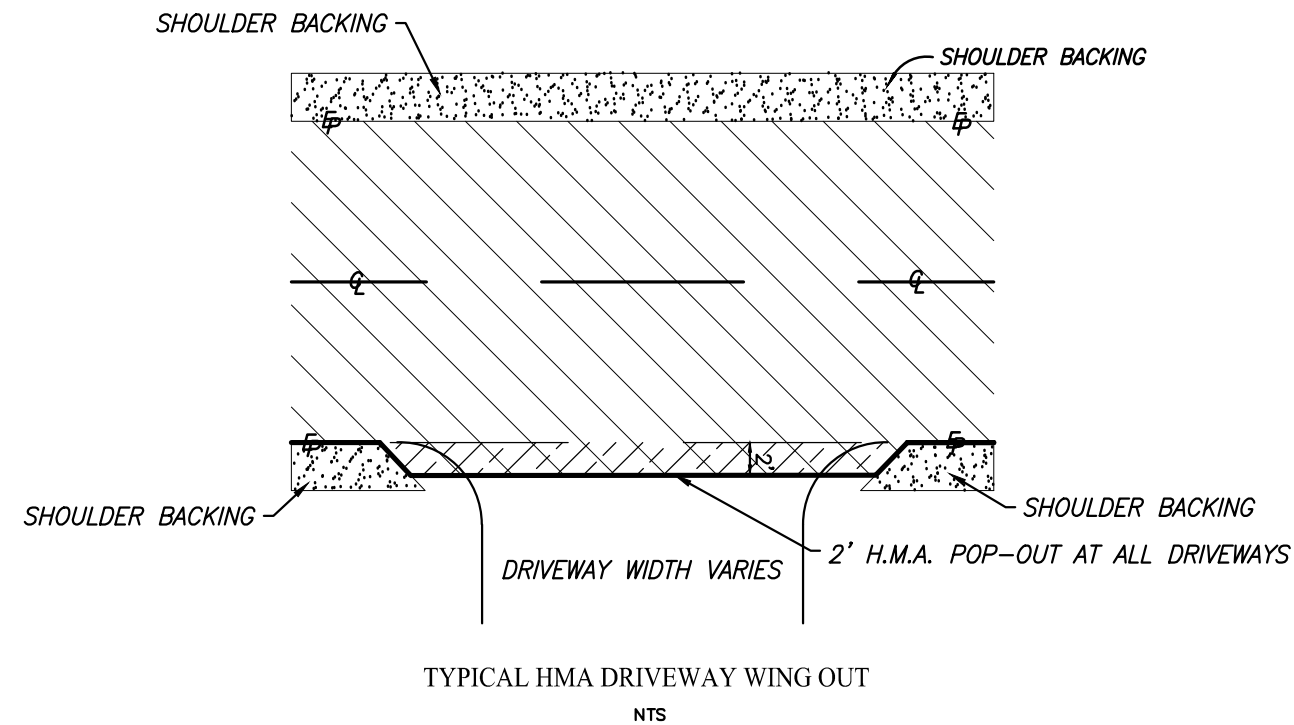
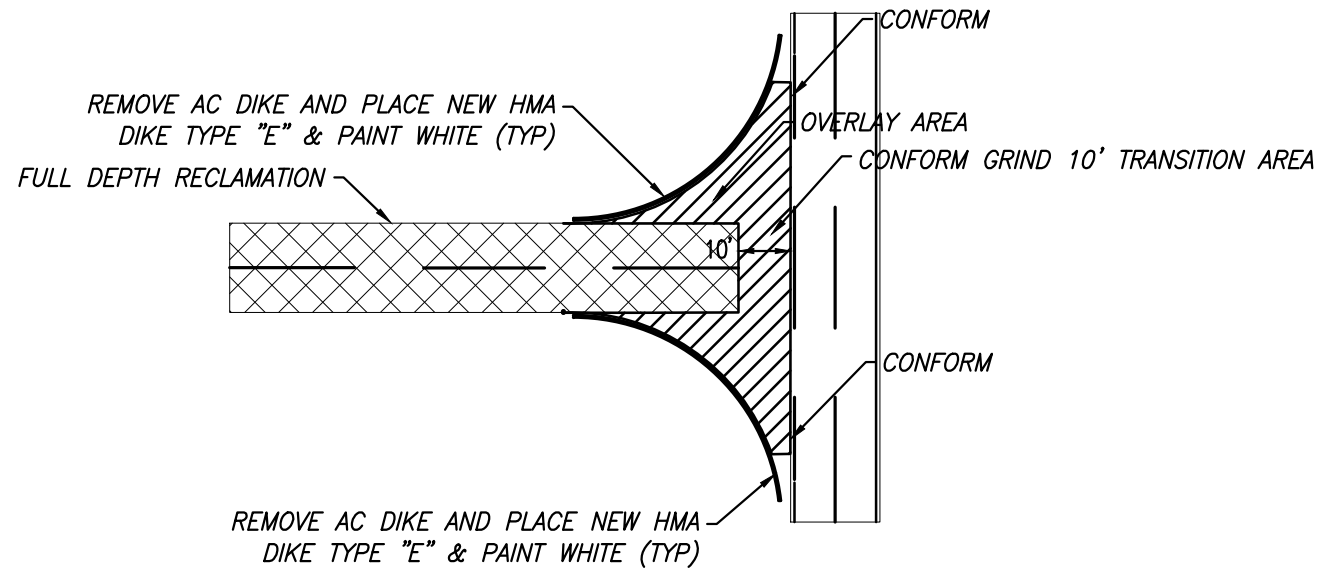
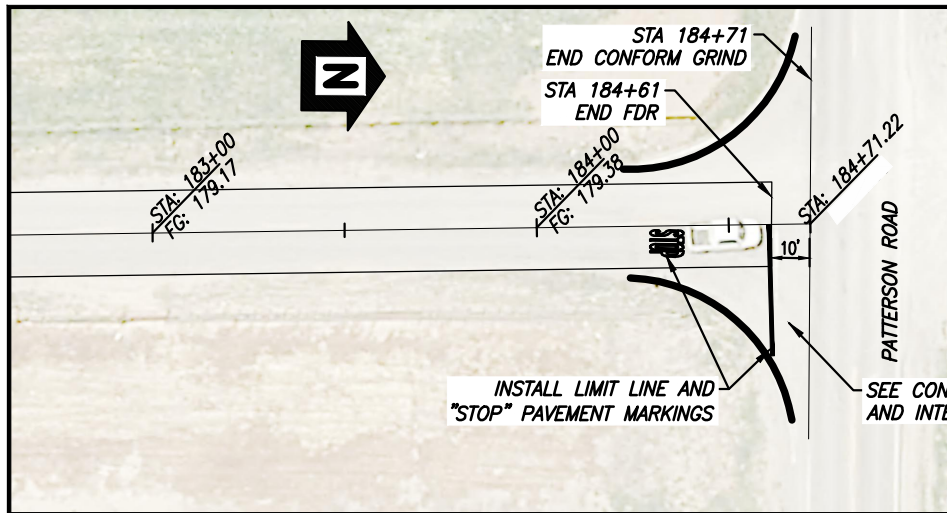

NOTE: MAX SLOPE GRADE CHANGE  $\frac{1}{2}\%$  TO EXISTING PAVEMENTS FOR SMOOTH TRANSITIONS

CONFORM GRIND TRANSITION & INTERSECTION DETAIL  
NTS

NOTES:

- CONTRACTOR SHALL EXCAVATE AND TRIM AFTER INITIAL PULVERIZATION TO A DEPTH FOR NEW H.M.A. ( $\pm 3"$ ) TO CONFORM WITH EXISTING ASPHALT CONCRETE
- PER RESIDENT ENGINEER'S DISCRETION TRIMMINGS MAY BE USED FOR SHOULDER BACKING
- THE ALGEBRAIC DIFFERENCE IN LONGITUDINAL GRADES SHALL NOT EXCEED 0.5%
- GRADE BREAKS SHALL NOT BE CLOSER TOGETHER THAN 50' AND A TOTAL OF ALL GRADE BREAKS WITHIN 200' SHALL NOT EXCEED 0.5%

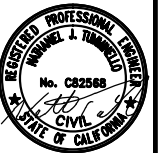

NO	DISCREPTIONS	DATE	APPROVED

STANISLAUS COUNTY  
DEPARTMENT OF PUBLIC WORKS  
ENGINEERING AND OPERATIONS DIVISION  
1716 MORGAN ROAD - MODESTO, CA 95358



BENTLEY ROAD  
STATION 183+58 TO 184+71 & CONSTRUCTION DETAILS  
IMPROVEMENT PLANS FOR:  
SB-1 ROADWAY RECONSTRUCTION PROJECT  
BENTLEY ROAD & WARNERVILLE ROAD  
STANISLAUS COUNTY, CA

JOB NO 9636  
DATE 4/1/2018  
DR BY JDI  
CK BY NT  
SCALE 1:50

SHEET NUMBER  
13  
OF 14 SHEETS





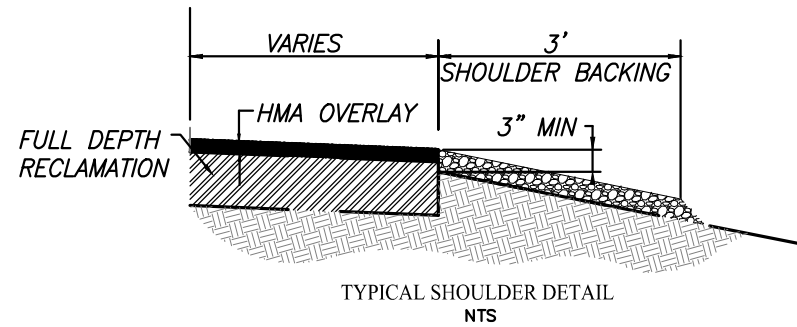
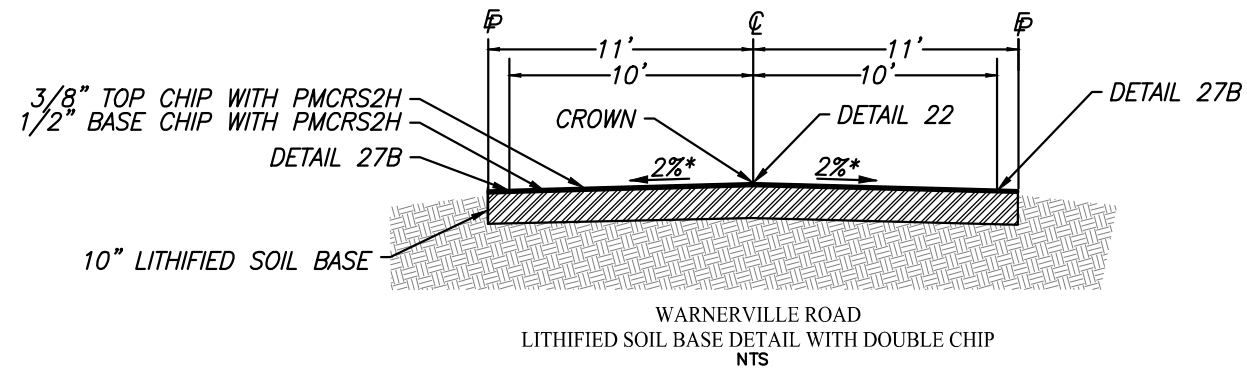
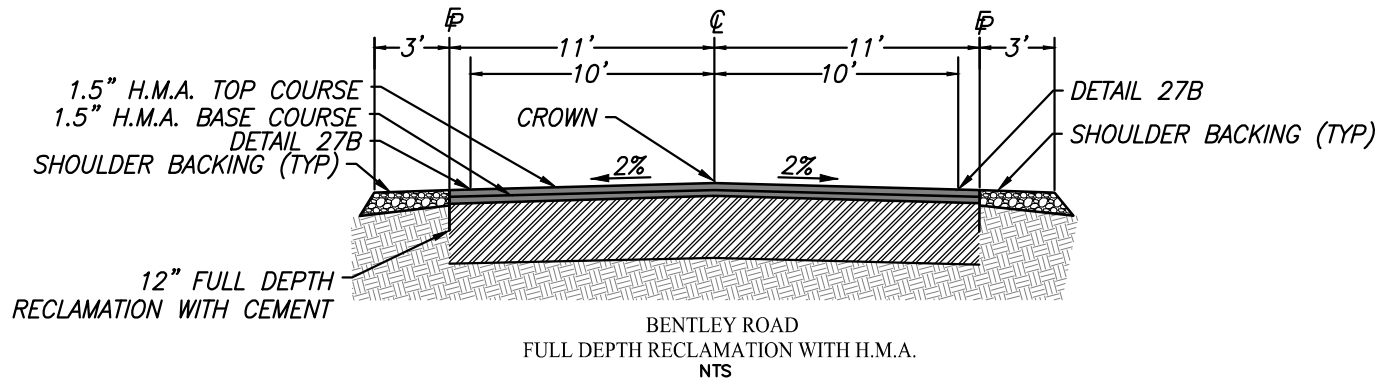

BENTLEY ROAD STRIPING PLAN

STATION	DETAIL 6	DETAIL 19	DETAIL 22	DETAIL 27B	DETAIL 27C	DETAIL 34A	PAVEMENT MARKINGS
0+05 to 5+05				1000'		500'	60 SF
5+05 to 27+10	2205'			4410'			53 SF
27+10 to 39+10		1200'		2400'			
39+10 to 39+70				60'	60'		60 SF
39+70 to 105+32			6562'	13124'			100 SF
105+75 to 110+75				1000		500'	47 SF
110+75 to 117+66	691'			1382'			53 SF
117+66 to 129+66		1200'		2400'			
129+66 to 129+96			30'	60			
129+96 to 141+96		1200'		2400'			
141+96 to 153+00			1104'	2208'			
153+00 to 165+00		1200'		2400'			
165+00 to 179+63	1463'			2926'			53 SF
179+63 to 184+63				1000'		500'	55 SF

WARNERVILLE ROAD STRIPING PLAN

1+00 to 282+90			28190'	56380'			100 SF
<b>TOTAL</b>	<b>4359'</b>	<b>4800'</b>	<b>35886'</b>	<b>93150'</b>	<b>60'</b>	<b>1500'</b>	<b>581 SF</b>

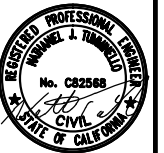

NO.	DESCRIPTIONS	DATE	APPROVED

**STANISLAUS COUNTY**  
 DEPARTMENT OF PUBLIC WORKS  
 ENGINEERING AND OPERATIONS DIVISION  
 1716 MORGAN ROAD - MODESTO, CA 95358



**CONSTRUCTION DETAILS**  
 IMPROVEMENT PLANS FOR:  
 SB-1 ROADWAY RECONSTRUCTION PROJECT  
 BENTLEY ROAD & WARNERVILLE ROAD  
 STANISLAUS COUNTY, CA

JOB NO 9636  
 DATE 4/1/2018  
 DR BY JDI  
 CK BY NT  
 SCALE 1:50

SHEET NUMBER  
**14**  
 OF 14 SHEETS

