

AN ORDINANCE AMENDING, TITLE 11 CHAPTER 11.08.020 PARKING ZONES ON SERVICE ROAD, RIVERSIDE DRIVE, FOX ROAD, CALIFORNIA AVENUE, AND LESTER ROAD IN THE STANISLAUS COUNTY UNINCORPORATED AREAS

The Board of Supervisors of the County of Stanislaus ordains as follows:

- I. Amend the Stanislaus County Code Title 11, Chapter 11.08.020 (Parking Zone), Subsection 440 (Service Road) and Subsection 423 (Riverside Drive) to read as follows:
 - “440. **Service Road:** On the north side of Service Road from its intersection with Crows Landing Road, to a point 2,130 feet east of the intersection.
 - 423. **Riverside Drive:** On the west side of Riverside Drive from its intersection with Nathan Avenue, north to a point 860 feet north of the intersection; and on the west side of Riverside Drive from a point 1,170 feet north of its intersection with Nathan Avenue; north 380 feet, to a point 1,550 feet north of the intersection.”
- II. Amend the Stanislaus County Code Title 11, Chapter 11.08.020 (Parking Zone), to add Subsection 528 (Fox Road), Subsection 529 (California Avenue) and Subsection 530 (Lester Road), as follows:
 - “528. **Fox Road:** On the north side of Fox Road from its intersection with Euclid Avenue to a point 195 feet east of the intersection; and, on the south side of Fox Road from its intersection with Euclid Avenue to a point 160 feet east of the intersection.
 - 529. **California Avenue:** On the north side of California Avenue from a point 430 feet west of its intersection with Pauline Avenue; west 330 feet, to a point 760 feet west of the intersection.
 - 530. **Lester Road:** On the east side of Lester Road from a point 815 feet north of its intersection with Main Street; north 95 feet, to a point 910 feet north of the intersection.”
- III. This ordinance shall take effect 30 days after its passage. The ordinance shall be published within 15 days of its passage, with the names of the members voting for and against the same in the Modesto Bee newspaper.

////

////

////

////

ORDINANCE NO. C.S. 1065

AN ORDINANCE AMENDING, TITLE 11 CHAPTER 11.08.020 PARKING ZONES ON SERVICE ROAD, RIVERSIDE DRIVE, FOX ROAD, CALIFORNIA AVENUE, AND LESTER ROAD IN THE STANISLAUS COUNTY UNINCORPORATED AREAS

Upon motion by Supervisor Chiesa, seconded by Supervisor Grover, the foregoing ordinance was passed and adopted at a regular meeting of the Board of Supervisors of the County of Stanislaus, State of California, this 4th day of August, 2009, by the following called vote.

AYES: Supervisors: O'Brien, Chiesa, Grover, Monteith, and Chairman
NOES: Supervisors: DeMartini
ABSENT: Supervisors: None

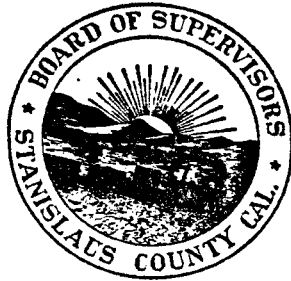

Jim DeMartini
Jim DeMartini
Chairman of the Board of Supervisors
of the County of Stanislaus, State of California

ATTEST:
Christine Ferraro Tallman
Clerk of the Board of Supervisors
of the County of Stanislaus, State of California

By: Terzi
Deputy Clerk

APPROVED AS TO FORM:
John P. Doering
County Counsel

By: Thomas E. Boze
Thomas E. Boze
Deputy County Counsel

W HACKETT RD

HACKETT RD

CORNUCOPIA WY

BUENAVENTURA DR

BROWN AVE

W SERVICE RD

No Parking Zone

CROWS LANDING RD

FARM SUPPLY DR



Service Rd. e/o Crows Landing Rd.

No Parking Zone
Location Map (Ceres)

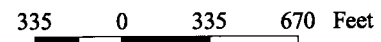

This map is for display purposes only.



Map printed: 7/2/2009





No Parking Zone



Riverside Dr. n/o Nathan Ave.

No Parking Zone
Location Map (Modesto)

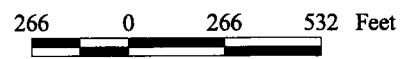

This map is for display purposes only.



Map printed: 7/2/2009

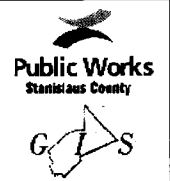

MULBERRY WY

7TH ST

THOMAS TAYLOR DR

EUCLID AVE

GEER RD

FOSBERG RD

No Parking Zone

FOX RD

No Parking Zone

6TH ST

LOCUST ST

LOCUST ST



Fox Rd. e/o Euclid Ave.

No Parking Zone

Location Map (Hughson)

287 0 287 574 Feet

This map is for display purposes only.

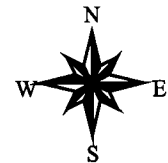

Map printed: 7/2/2009



GARRISON AVE

PAULINE AVE

GRIMES AVE

CALIFORNIA AVE

CALIFORNIA AVE

No Parking Zone

COOK AVE



California Ave. w/o Pauline Ave.

No Parking Zone
Location Map (West Modesto)

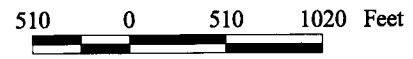

This map is for display purposes only.



Map printed: 7/2/2009



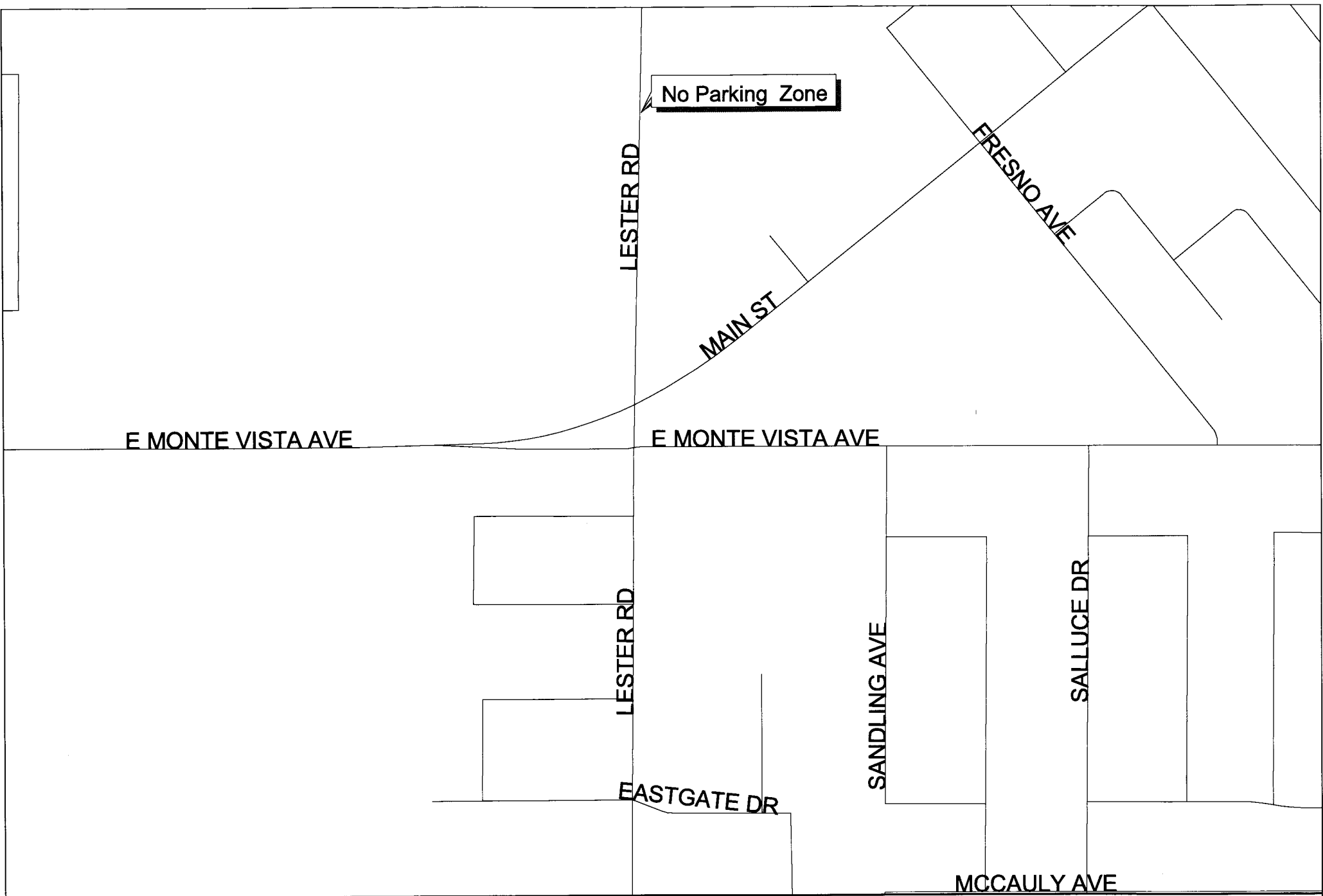

Lester Rd. n/o Main St.

No Parking Zone
 Location Map (Denair)

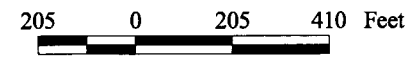

This map is for display purposes only.



Map printed: 7/2/2009



**DECLARATION OF PUBLICATION
(C.C.P. S2015.5)**

**COUNTY OF STANISLAUS
STATE OF CALIFORNIA**

I am a citizen of the United States and a resident Of the County aforesaid; I am over the age of Eighteen years, and not a party to or interested In the above entitle matter. I am a printer and Principal clerk of the publisher of **THE MODESTO BEE**, printed in the City of **MODESTO** , County of **STANISLAUS** , State of California, daily, for which said newspaper has been adjudged a newspaper of general circulation by the Superior Court of the County of **STANISLAUS** , State of California, Under the date of **February 25, 1951, Action No. 46453**; that the notice of which the annexed is a printed copy, has been published in each issue there of on the following dates, to wit:

Aug 10, 2009

I certify (or declare) under penalty of perjury That the foregoing is true and correct and that This declaration was executed at

MODESTO, California on

September 28th, 2009

(Signature)



PUBLIC NOTICE
ORDINANCE NO. C.S. 1065
AN ORDINANCE AMENDING, TITLE 11
CHAPTER 11.08.020 PARKING ZONES
ON SERVICE ROAD, RIVERSIDE
DRIVE, FOX ROAD, CALIFORNIA AVE-
NUE, AND LESTER ROAD IN THE
STANISLAUS COUNTY UNINCORPOR-
ATED AREAS. The Board of Supervi-
sors of the County of Stanislaus ordains as
follows: I. Amend the Stanislaus County
Code Title 11, Chapter 11.08.020 (Parking
Zone), Subsection 440 (Service Road) and
Subsection 423 (Riverside Drive) to read
as follows: "440. Service Road: On the north
side of Service Road from its intersection
with Crows Landing Road, to a point 2,130
feet east of the intersection. 423. Riverside
Drive: On the west side of Riverside Drive
from its intersection with Nathan Avenue,
north to a point 860 feet north of the inter-
section; and on the west side of Riverside
Drive from a point 1,170 feet north of its in-
tersection with Nathan Avenue; north 380
feet, to a point 1,550 feet north of the
intersection." II. Amend the Stanislaus
County Code Title 11, Chapter 11.08.020
(Parking Zone), to add Subsection 528
(Fox Road), Subsection 529 (California
Avenue) and Subsection 530 (Lester
Road), as follows: "528. Fox Road: On the
north side of Fox Road from its intersection
with Euclid Avenue to a point 195 feet east
of the intersection; and, on the south side
of Fox Road from its intersection with Eu-
clid Avenue to a point 160 feet east of the
intersection. 529. California Avenue: On
the north side of California Avenue from a
point 430 feet west of its intersection with
Pauline Avenue; west 330 feet, to a point
760 feet west of the intersection. 530. Les-
ter Road: On the east side of Lester Road
from a point 815 feet north of its intersec-
tion with Main Street; north 95 feet, to a
point 910 feet north of the intersection." III.
This ordinance shall take effect 30 days af-
ter its passage. The ordinance shall be
published within 15 days of its passage,
with the names of the members voting for
and against the same in the Modesto Bee
newspaper. Upon motion by Supervisor
Chiesa, seconded by Supervisor Grover,
the foregoing ordinance was passed and
adopted at a regular meeting of the Board
of Supervisors of the County of Stanislaus,
State of California, this 4th day of August,
2009, by the following called vote: AYES:
Supervisors: O'Brien, Chiesa, Grover, Mon-
teith and Chairman DeMartini; NOES: Su-
pervisors: None; ABSENT: Supervisors:
None. Jim DeMartini, Chairman of the
Board of Supervisors of the County of
Stanislaus, State of California . ATTEST:
Christine Ferraro Tallman, Clerk of the
Board of Supervisors of the County of
Stanislaus, State of California; By: Suzi
Seibert, Deputy Clerk. APPROVED AS TO
FORM: John P. Doering, County Counsel;
By: Thomas E. Boze, Deputy County Coun-
sel.
Pub Dates Aug 10, 2009