

**THE BOARD OF SUPERVISORS OF THE COUNTY OF STANISLAUS
ACTION AGENDA SUMMARY**

DEPT: CHIEF EXECUTIVE OFFICE

BOARD AGENDA # *B-11

Urgent Routine X

AGENDA DATE March 27, 2001

CEO Concur with Recommendation YES ght NO
(Information Attached)

4/5 Vote Required YES NO X

SUBJECT: APPROVAL OF A TIME EXTENSION TO THE CONTRACT WITH DIEDE CONSTRUCTION AND APPROVAL OF THE INSTALLATION OF TWO ADDITIONAL MODULARS FOR STANISLAUS COUNTY OFFICE OF EDUCATION

STAFF
RECOMMEN-
DATIONS:

1. APPROVE A TIME EXTENSION FOR ADVERSE WEATHER DAYS FOR THE CONTRACT WITH DIEDE CONSTRUCTION COMPANY FOR THE CONSTRUCTION OF THE CERES RECOVERY CENTER.

2. APPROVE THE INSTALLATION OF TWO ADDITIONAL MODULAR CLASSROOMS FOR THE STANISLAUS COUNTY OFFICE OF EDUCATION.

FISCAL
IMPACT:

The Board of Supervisors approved a project budget of \$2,700,000 for the renovation of the Stanislaus Recovery Center. The time extension will not affect the overall project budget and the Stanislaus Behavioral Health and Recovery Services in partnership with the Office of Education has agreed to fund the cost of the installation of the additional modulars.

BOARD ACTION AS FOLLOWS:

No. 2001-227

On motion of Supervisor Blom , Seconded by Supervisor Mayfield
and approved by the following vote,

Ayes: Supervisors: Mayfield, Blom, Simon, Caruso, and Chair Paul

Noes: Supervisors: None

Excused or Absent: Supervisors: None

Abstaining: Supervisor: None

1) X Approved as recommended

2) Denied

3) Approved as amended

Motion:



ATTEST: CHRISTINE FERRARO TALLMAN, Clerk

By: Deputy

File No.

DISCUSSION: On February 6, 2001 the Board awarded a contract to Diede Construction Company for the construction of the Ceres Recovery Center. A Notice to Proceed was issued to Diede and the first day of their contract was February 12, 2001. Between February 12, 2001 and February 26, 2001 the contractor has been delayed eight days due to adverse weather. The delay has been documented and confirmed by the Construction Manager. The revised completion date for the project will be July 11, 2001.

On December 14, 2000, the Board accepted the Program Plan for the Stanislaus County Recovery Center. That plan included a partnership with the Stanislaus County Office of Education and the Ceres Unified School District to integrate treatment and education. On October 3, 2000, the Board approved the Master Plan prepared for the site.

The Master Plan included an area on the southeast parking lot for adolescent treatment. The adolescent treatment included a modular unit furnished and installed by the County as a treatment facility and a modular unit furnished and installed by the Office of Education as a classroom facility. A fence surrounded the area to separate the adolescents and adults.

Since the Master Plan was approved, the program for adolescent treatment has grown. Also, more facilities are needed. The Office of Education is furnishing and installing two additional modulars, one for classroom space and the other for a dining area. The area on the site, set aside in the original Master Plan, is large enough to accommodate the growth. Attached is a copy of the revised Master Plan showing these units within the original master planned space.

As a result of the additional modulars the electrical service to the area must be increased and some changes made to the utilities serving the modulars. The Construction Manager is identifying the cost of these charges and the Stanislaus Behavioral Health and Recovery Services in partnership with the Office of Education has agreed to fund the additional cost. The Construction Manager currently does not anticipate an impact to the schedule but will review further with Turlock Irrigation District.

POLICY ISSUE: The additional services available at this site will enhance the Board of Supervisors priorities ensuring a safe, healthy community, delivering excellent community service and promoting official government operations.

STAFFING IMPACT: There will be no staffing impact to Stanislaus County. The County's partners in the program will furnish any additional staffing required for the expanded education program.

EXISTING BUILDING

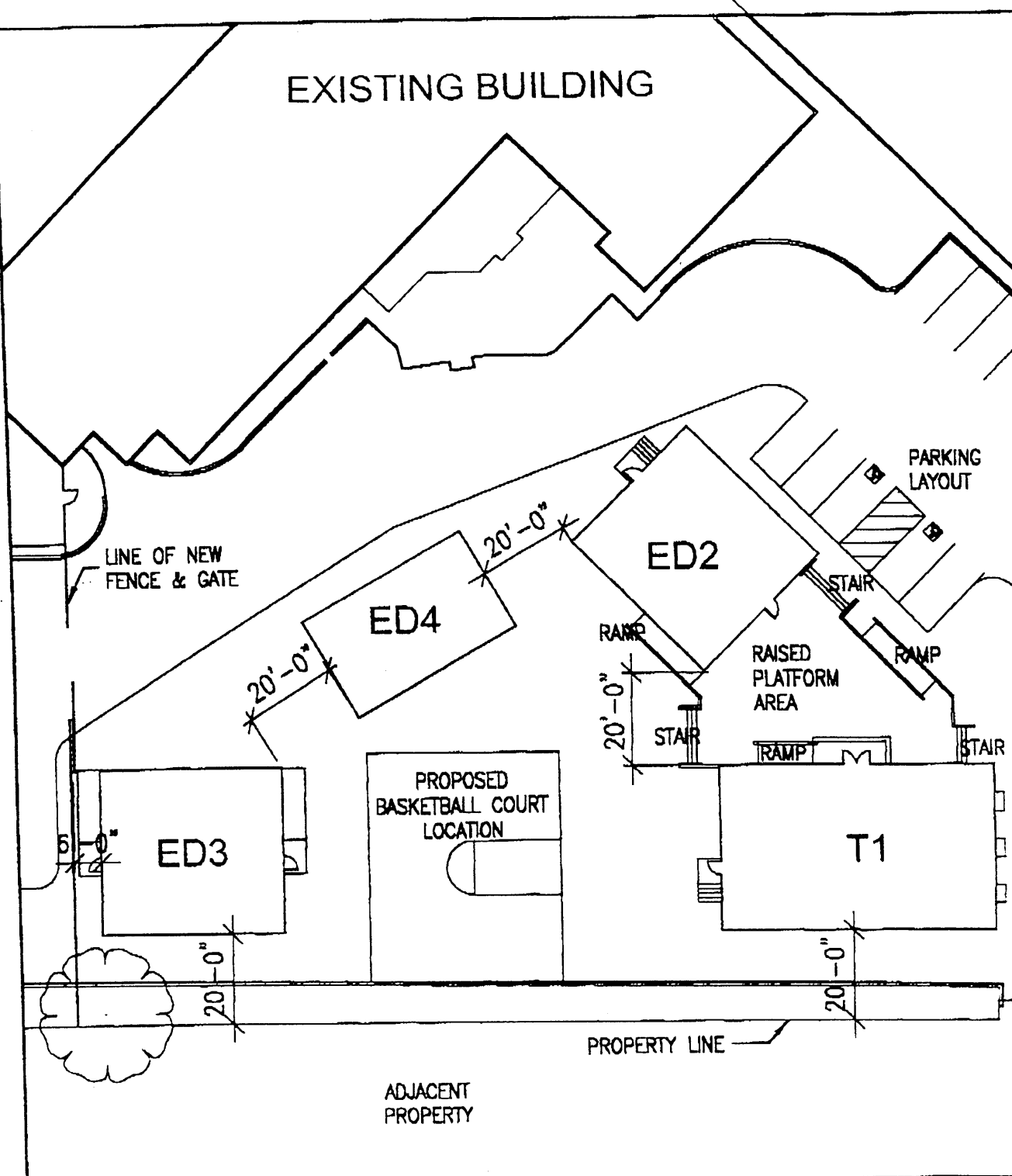

PROJECT
LOCATION AND LAYOUT OF PROPOSED MODULAR
BUILDINGS AT THE STANISLAUS RECOVERY CENTER
MODESTO, CA

BAHR
ARCHITECTS

1119 PINE STREET, SUITE A
MENLO PARK, CA 94022
TEL. 650-596-1979
FAX 650-330-0820

TITLE PROPOSED MODULAR LAYOUT	SCALE 1/32"=1'-0"	DATE 03-10-01	SK 01
----------------------------------	----------------------	------------------	----------